

Read before installation.

All bolts have to be finally tighten after installation all parts on vehicle.

Crash bar down

CF Moto 450 MT 25

ID:3083924

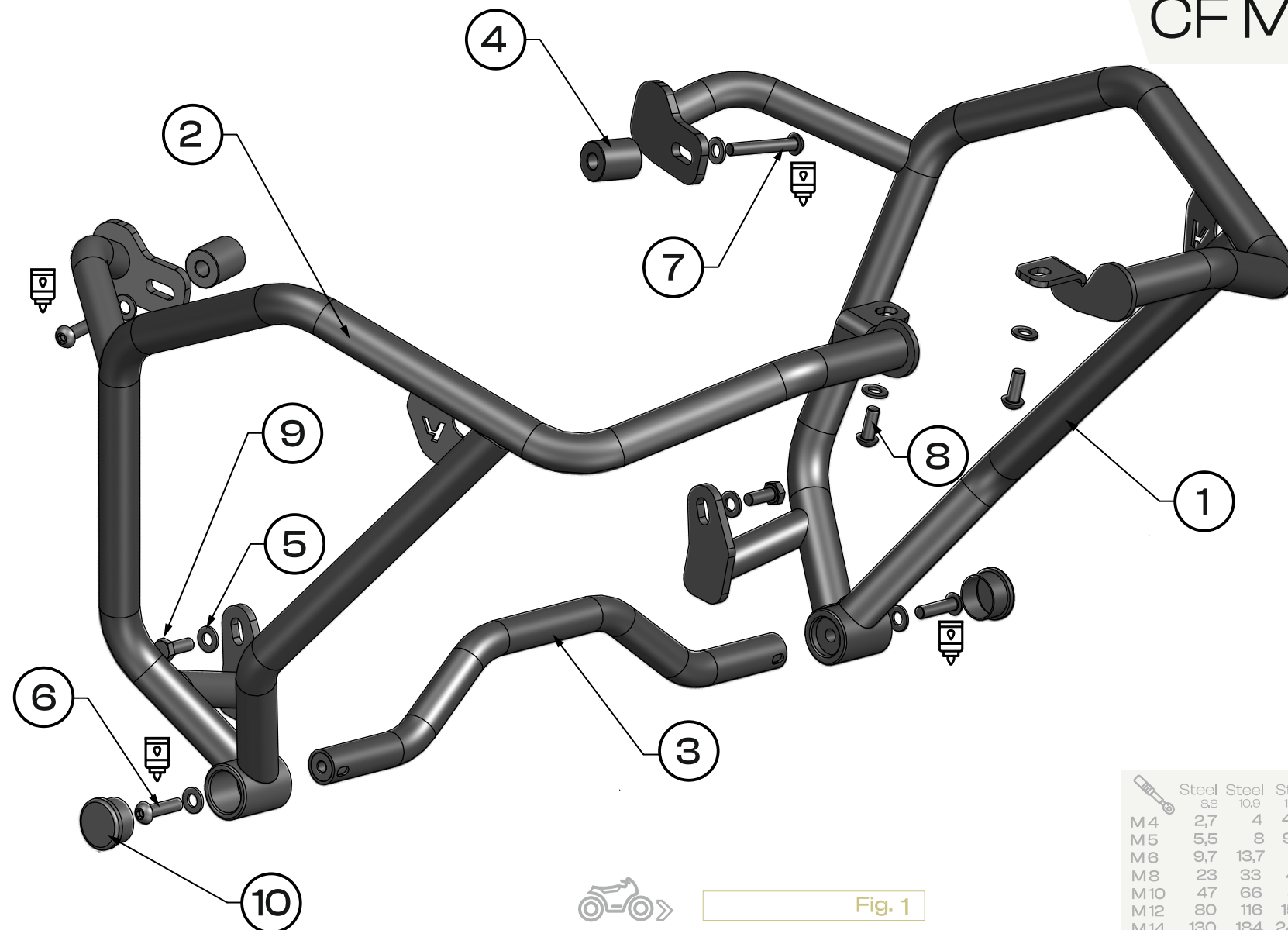

- 1** Left crash bar
 1x
- 2** Right crash bar
 1x
- 3** Crash bar connector
 1x
- 4** Spacer sleeve
 2x
 D25xd10xH29
- 5** Washer
 8x
 M8-DIN 125
- 6** Bolt
 2x
 M8x30-DIN 7380
- 7** Bolt
 2x
 M8x50-DIN 7380
- 8** Bolt
 2x
 M8x20-DIN 7380
- 9** Bolt
 2x
 M8x20-DIN 933
- 10** End caps
 2x

	Steel 8.8	Steel 10.9	Steel 12.9
M4	2,7	4	4,9
M5	5,5	8	9,8
M6	9,7	13,7	16
M8	23	33	40
M10	47	66	83
M12	80	116	150
M14	130	184	240
M16	196	287	350
M18	270	395	490
M20	385	560	690

 one person
  use a medium-strength
  tighten with torque
 OEM Original Equipment Manufacturer

Yoikk EXP

assembly instructions

yokkexp.com



**EXPLORE
POSSIBILITIES**

!!! Initially, attach the screws loosely.

After assembling everything together, tighten them with the appropriate force.

follow  yakkexp join #yakkherd

1. Unscrew and remove the OEM screws. Repeat this step on the opposite side of the motorcycle.
2. Mount the crash bars on both sides as shown in the drawing using bolt [7], washer [5], and sleeve [4]. [Fig. 3], [Fig. 4]
3. Mount the crash bar at the second mounting point using the supplied bolt [9] and washer [5]. [Fig. 3], [Fig. 5]

Use medium-strength adhesive and repeat this step on the opposite side of the motorcycle..

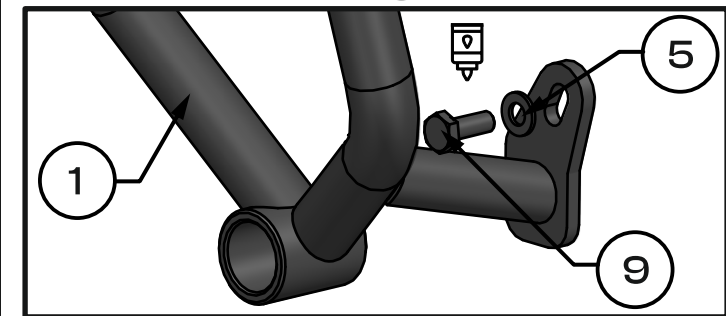
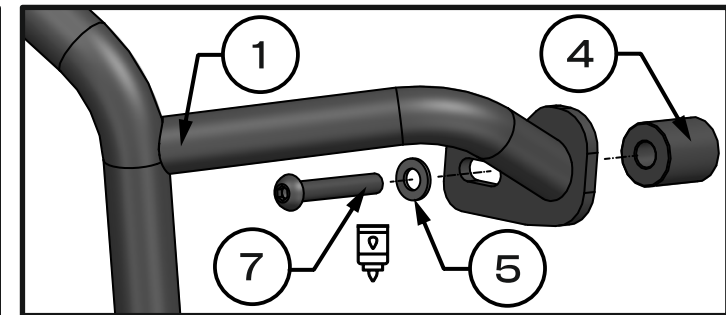
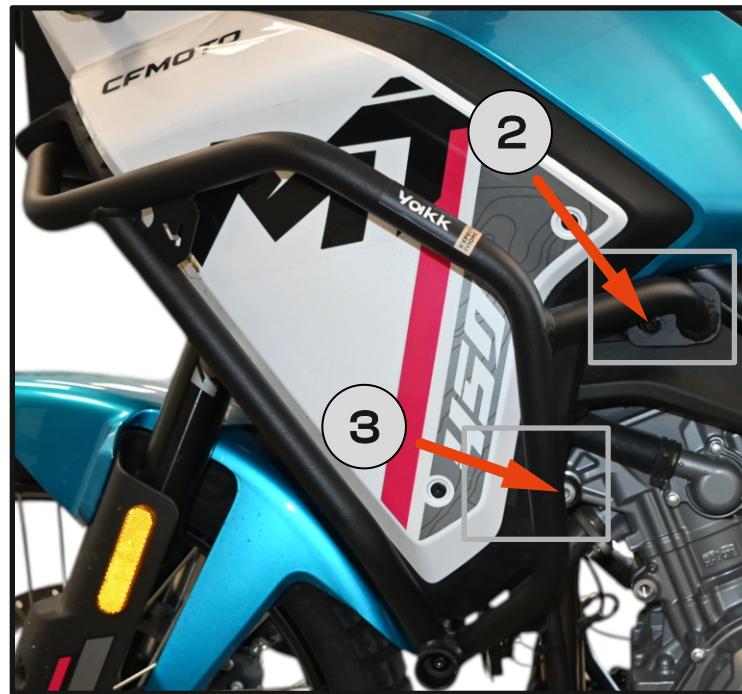
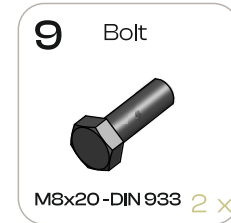

!!! Initially, attach the screws loosely.

After assembling everything together, tighten them with the appropriate force.

4. Mount both crash bars to the mounting points under the headlight using the bolts **[2]** and washer **[5]**. **[Fig. 4], [Fig. 5]**

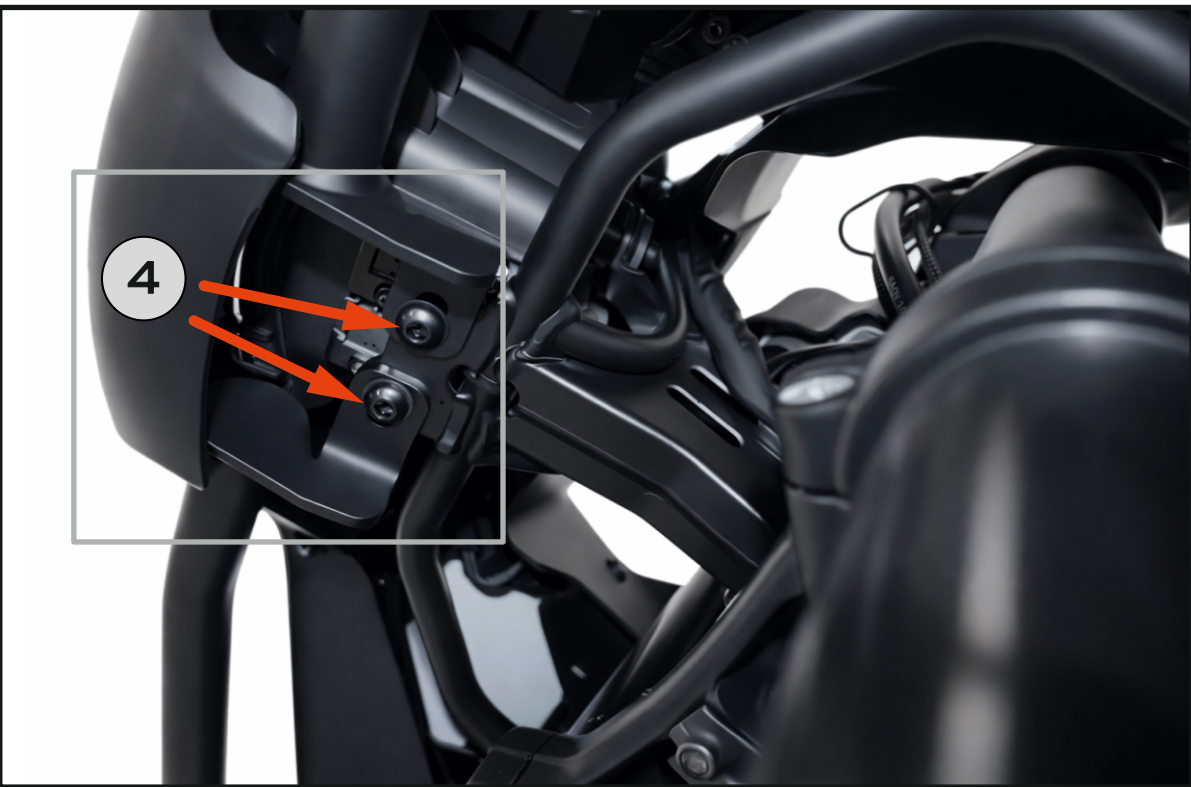

Fig. 4

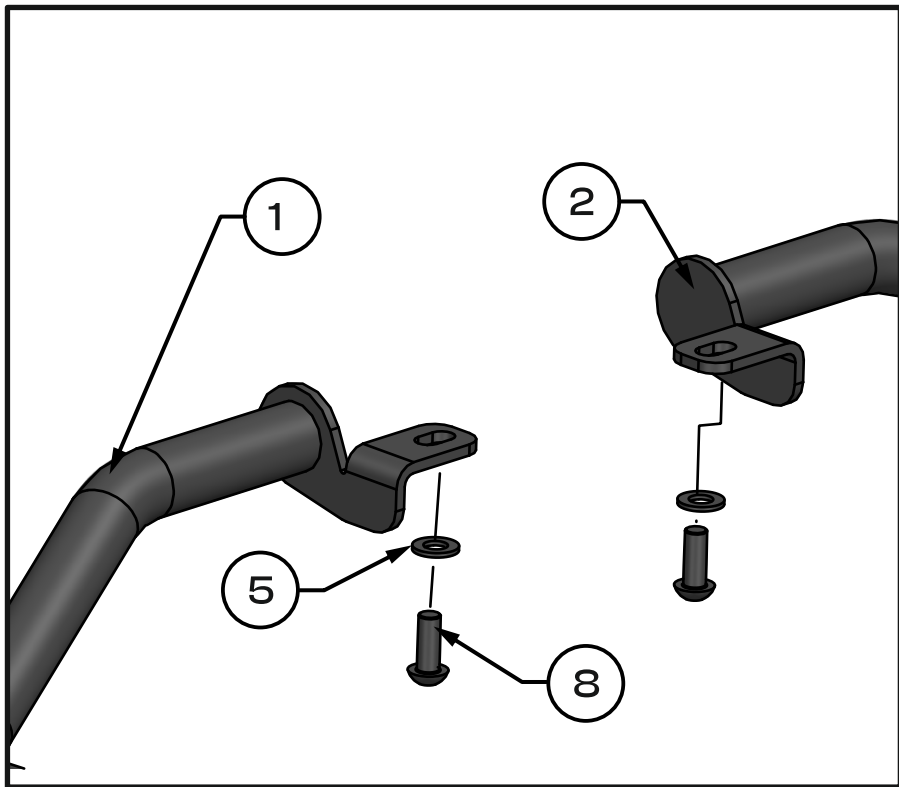

Fig. 5



!!! Initially, attach the screws loosely.

After assembling everything together, tighten them with the appropriate force.

4. Mount and secure the crash bar connector in the position shown in the illustration using the bolts [6] and washer [5].
Use medium-strength adhesive and repeat this step on the opposite side of the motorcycle. [Fig. 6], [Fig. 7]

Align the crash bars with the motorcycle axis and tighten all bolts to the specified torque.

5. Install the protective end caps [10]. [Fig. 8]

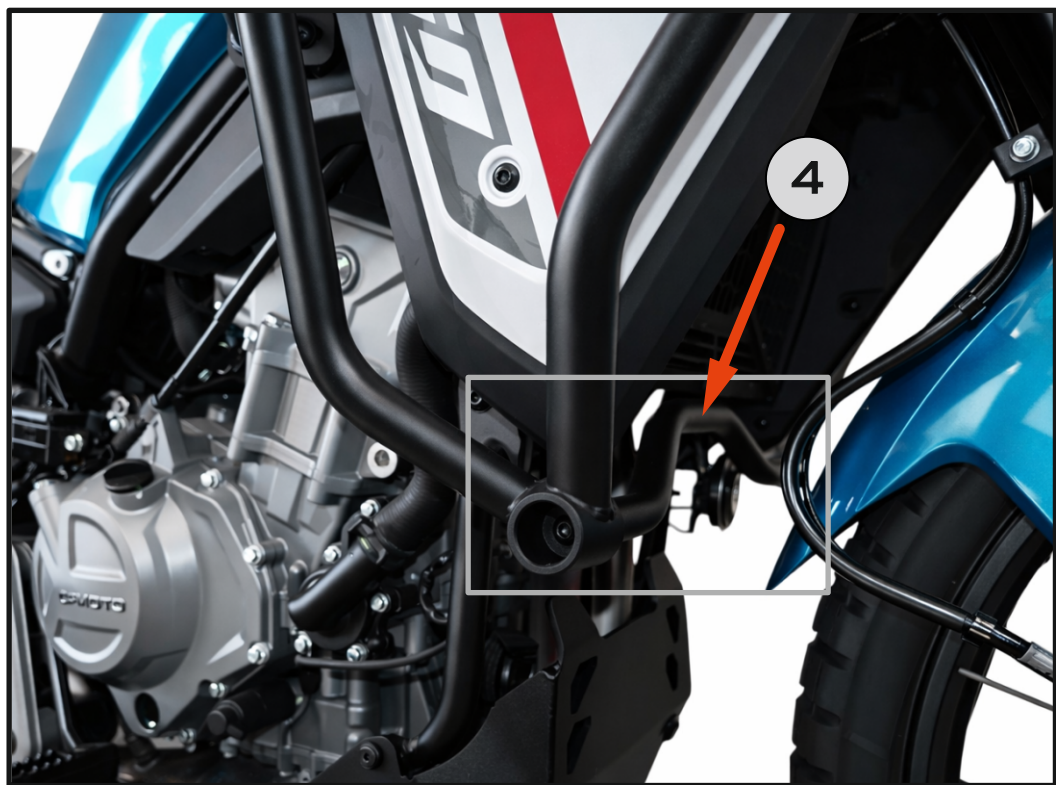

Fig. 6



Fig. 8

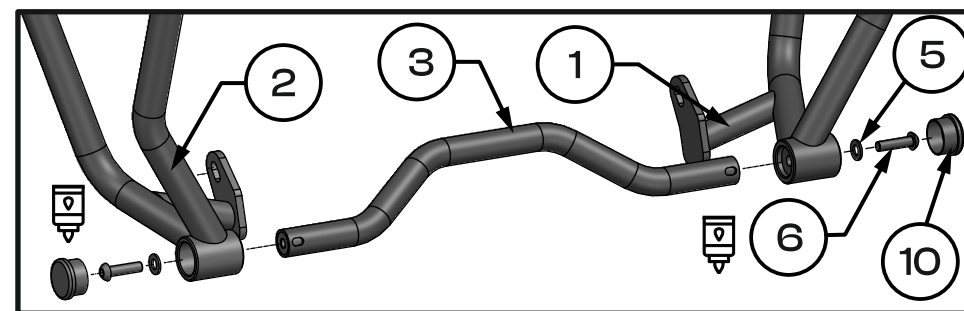

Fig. 7

