

33+40

HEAVY CAVALRY PANNIERS

USER MANUAL



Safety Warning

- Safety first. Please read this manual carefully before installation. Incorrect installation may cause the panniers to detach while riding and lead to a serious accident.
- When installing or removing the panniers, make sure the motorcycle is stable, for example use the center stand, and turn off the engine.
- Regularly check all connection points such as hooks, straps, and buckles for wear or damage to ensure they are in good condition before long rides.
- Keep the panniers and straps away from the exhaust, wheels, chain, brake discs, and all moving or high temperature components.
- Distribute items evenly inside the bags. Avoid having the center of gravity too high or too much to one side.



Parts Checklist

- Before starting the installation, please confirm that you have received all of the following components:

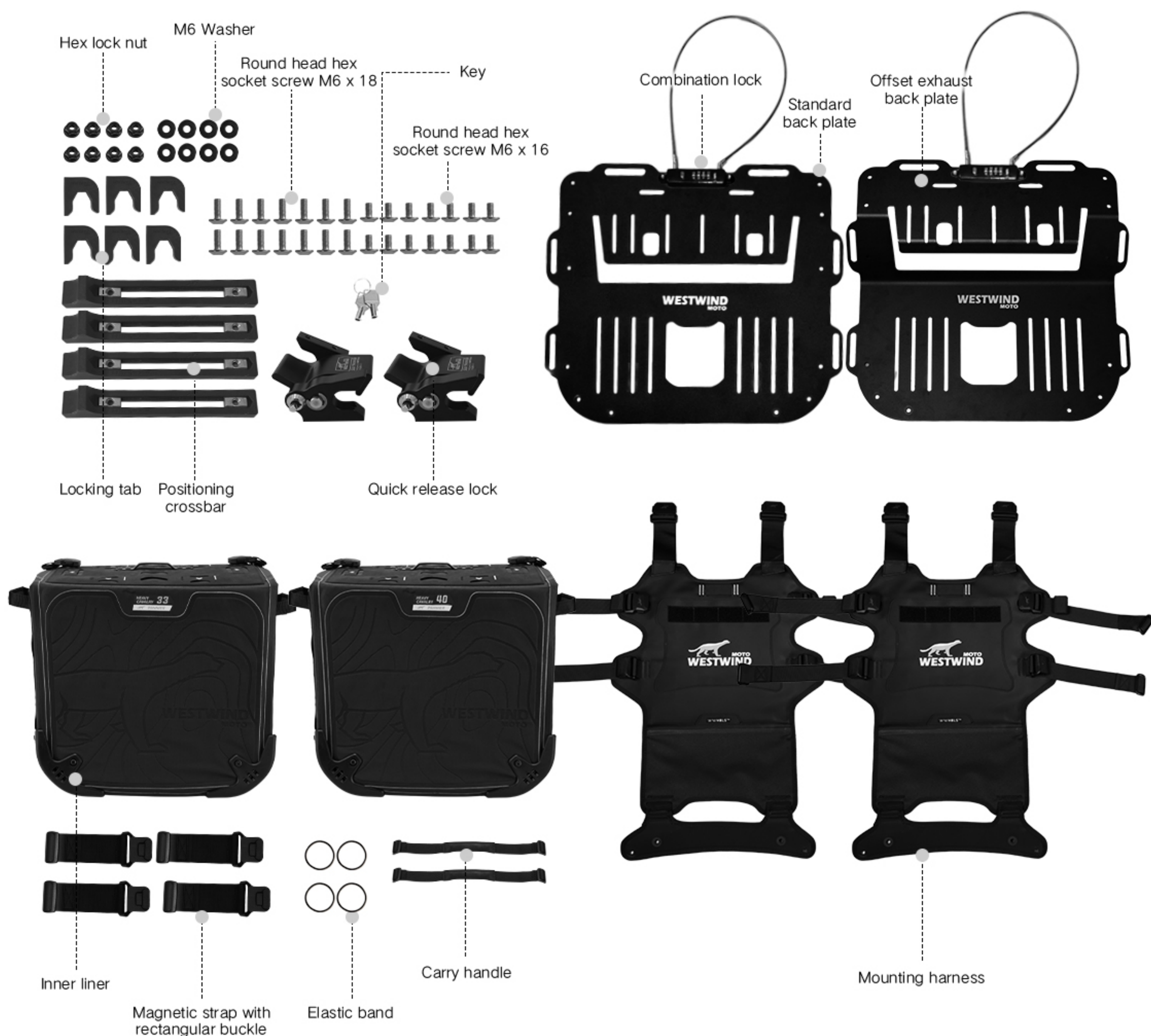



Installation Steps

- This section is the core of the installation process. The text should match the images step by step, following the sequence "Step 1, Step 2, Step 3...".
- Before tightening the screws, apply a small amount of thread locker (about the size of a grain of rice) to the screws for added stability. The following steps demonstrate installation on the offset exhaust side; the standard side installation follows the same procedure.

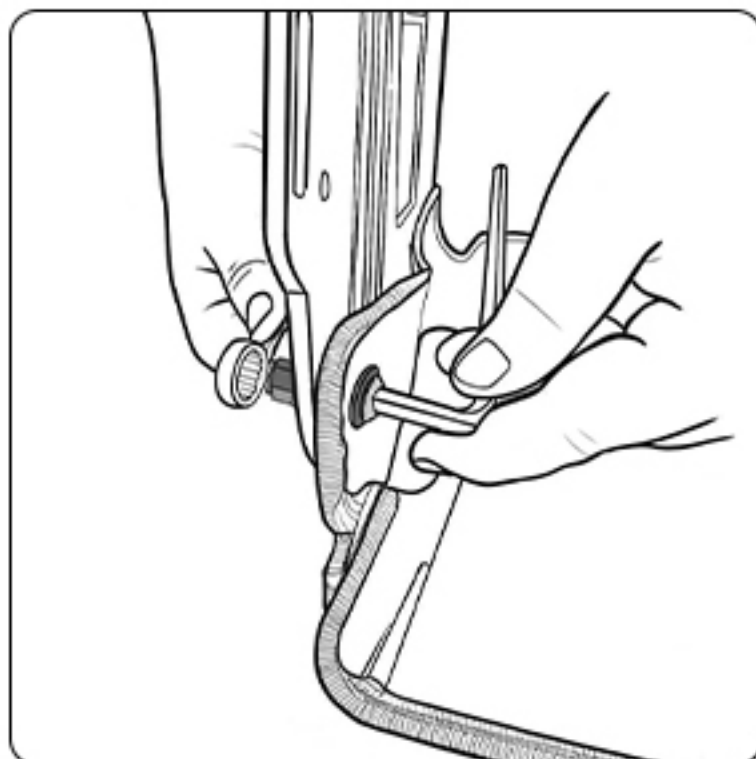

STEP1

Align the holes on the bottom of the mounting harness with those on the back plate. Insert the screw through the washer, then tighten with the nut.

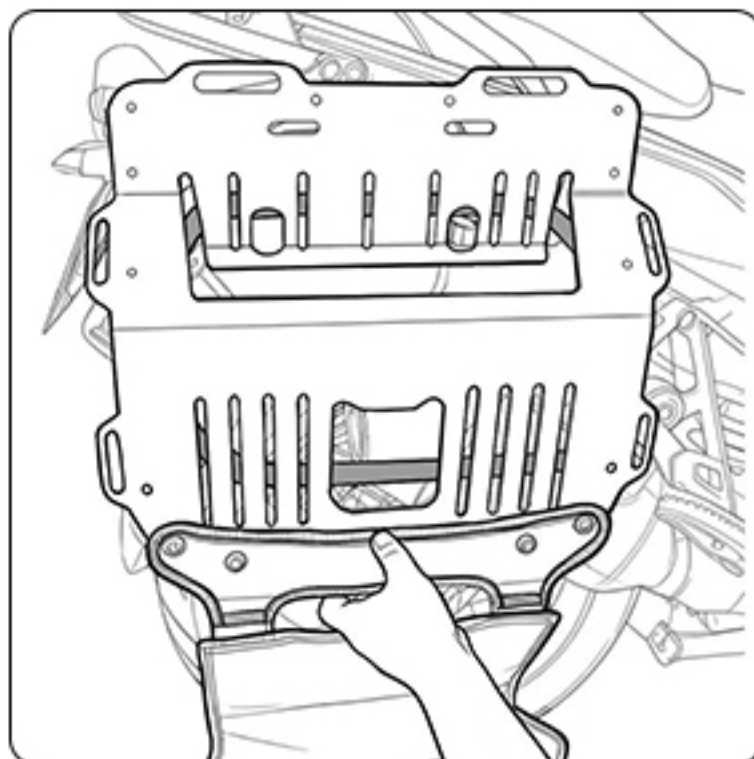

STEP2

Position the back plate on the side rack and align it correctly.

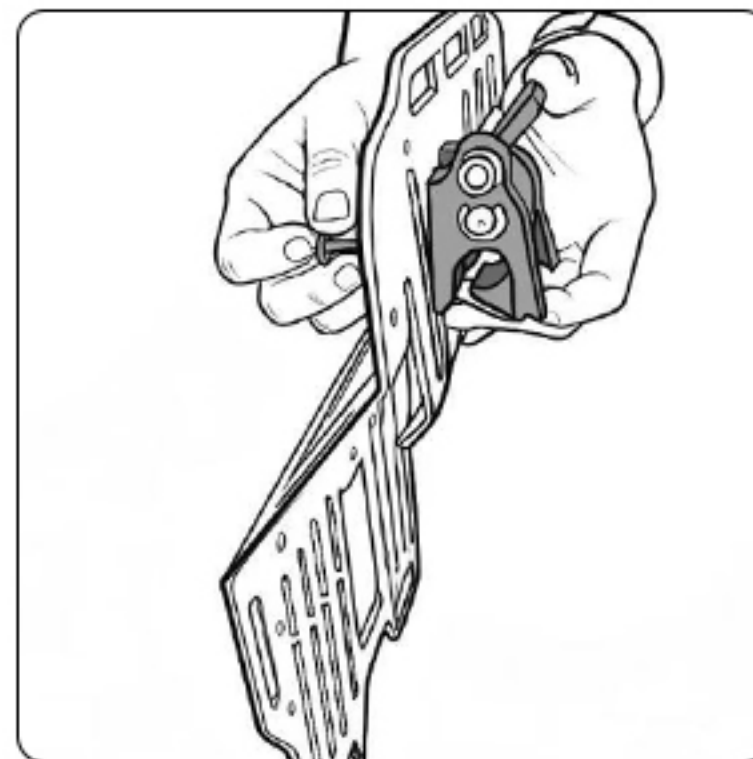

STEP3

Install the quick release lock on the back of the plate (the side with the logo). Rotate the lock head toward the marked direction until secure, then loosely fasten it with the short screws.

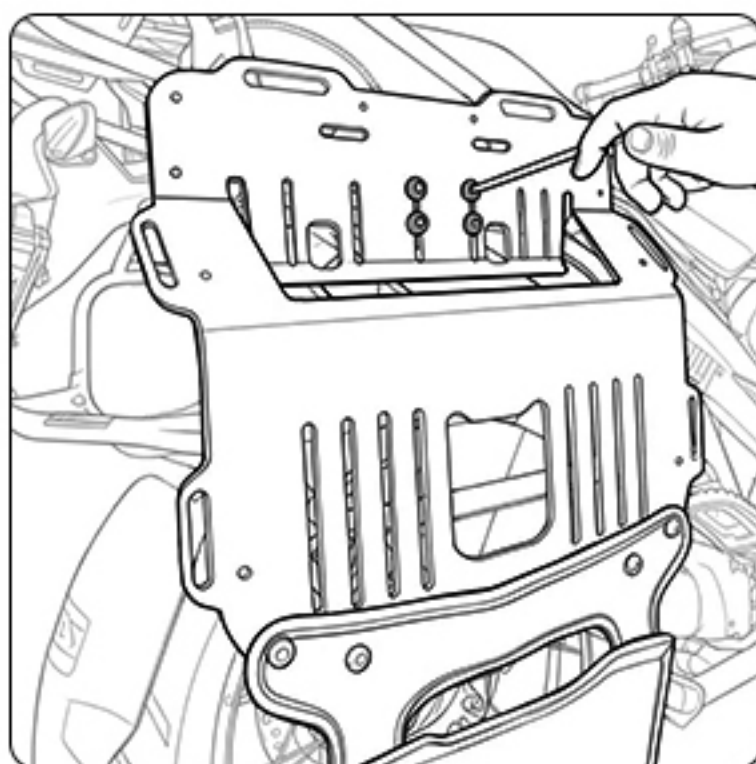

STEP4

Clamp the back plate onto the side rack to check if the position fits correctly. If the quick release lock is engaged, you can unlock it with the key.

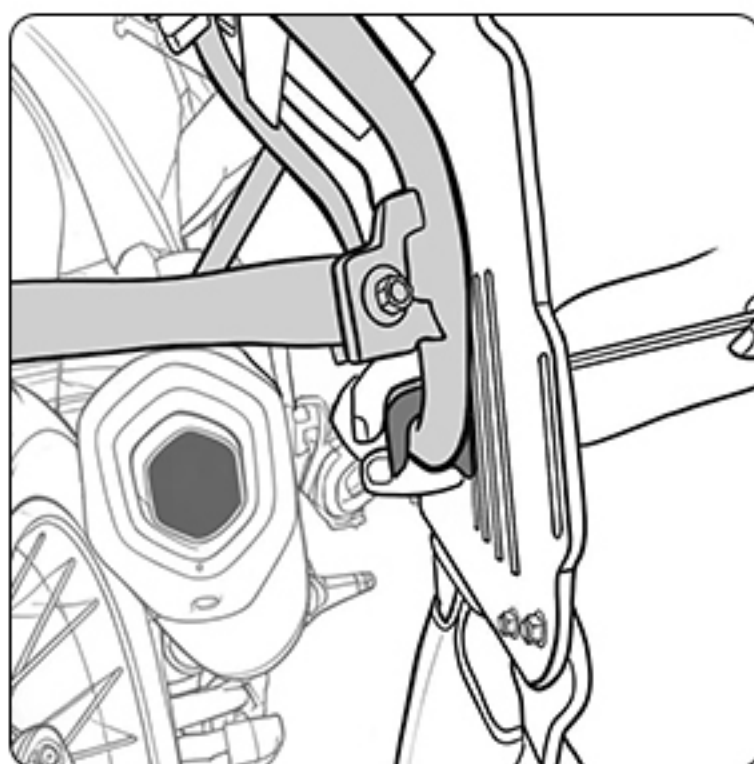

STEP5

Install the locking tabs on both lower sides, preferably near the outer edges. Hold the tab firmly by hand, using long screws for the upper holes and short screws for the lower ones.

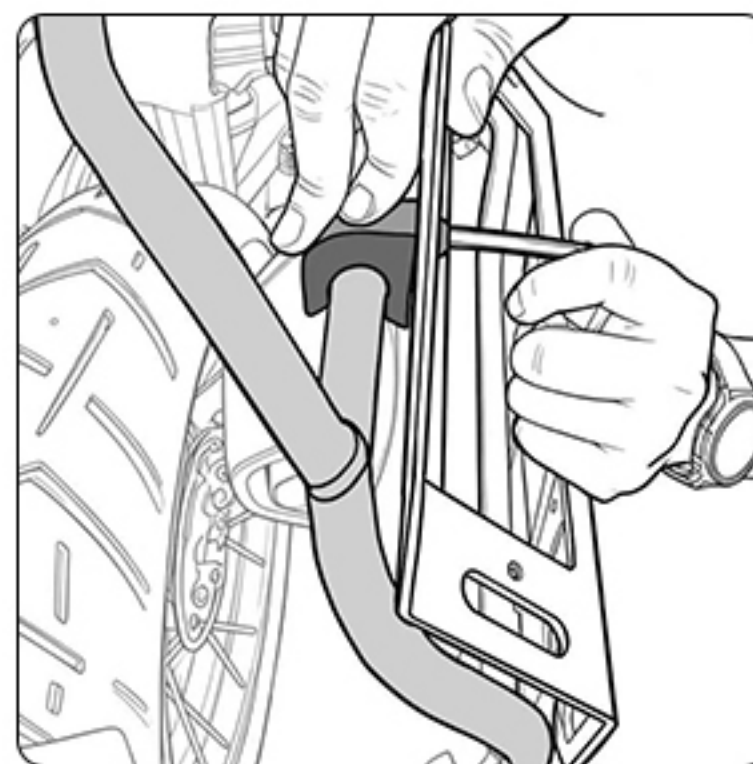

STEP6

Once the locking tabs are positioned on the side rack, align the holes and tighten the screws. Use long screws for the upper holes and short screws for the lower holes.

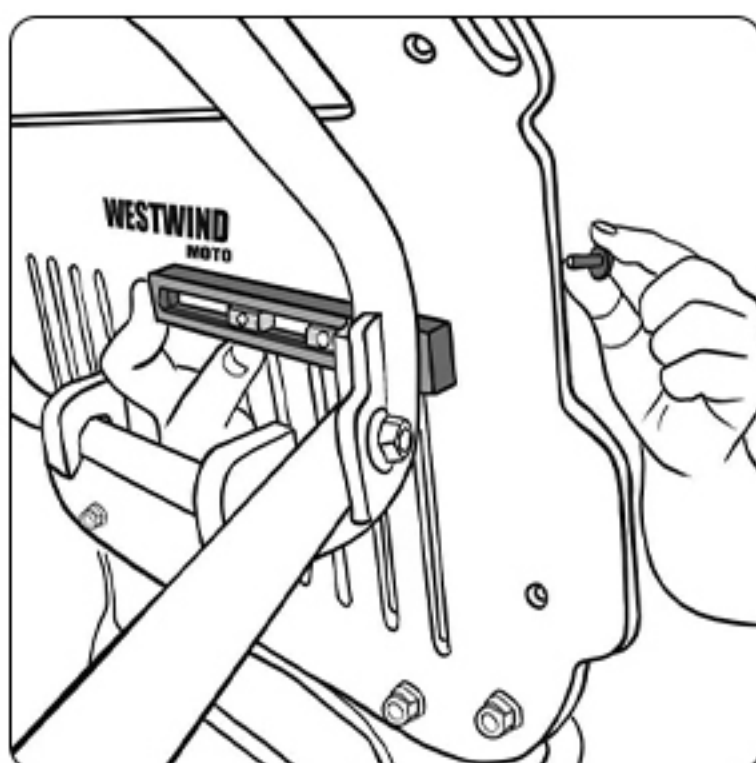

STEP7

Place the positioning crossbar against the rack, then move the sliding nuts to align with the holes. Hold the crossbar firmly against the rack and tighten with long screws. Install on both sides. Once the back plate is aligned, securely tighten all screws.

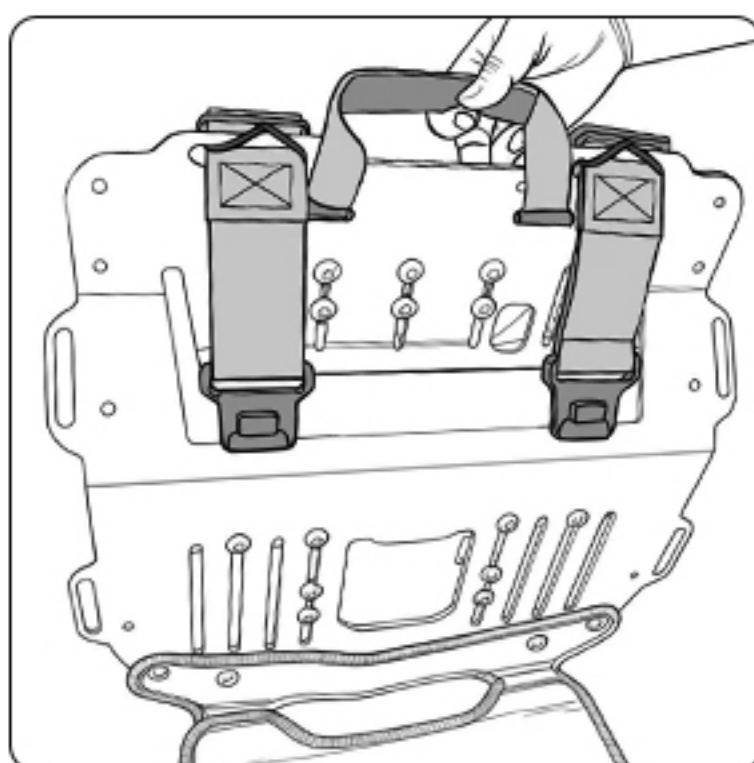

STEP8

Remove the back plate from the motorcycle. Thread the handle and magnetic strap with rectangular buckle through the corresponding holes at the top of the back plate. Secure the magnetic strap with the elastic band.



STEP9

Insert the inner liner, then fasten the upper magnetic buckle.

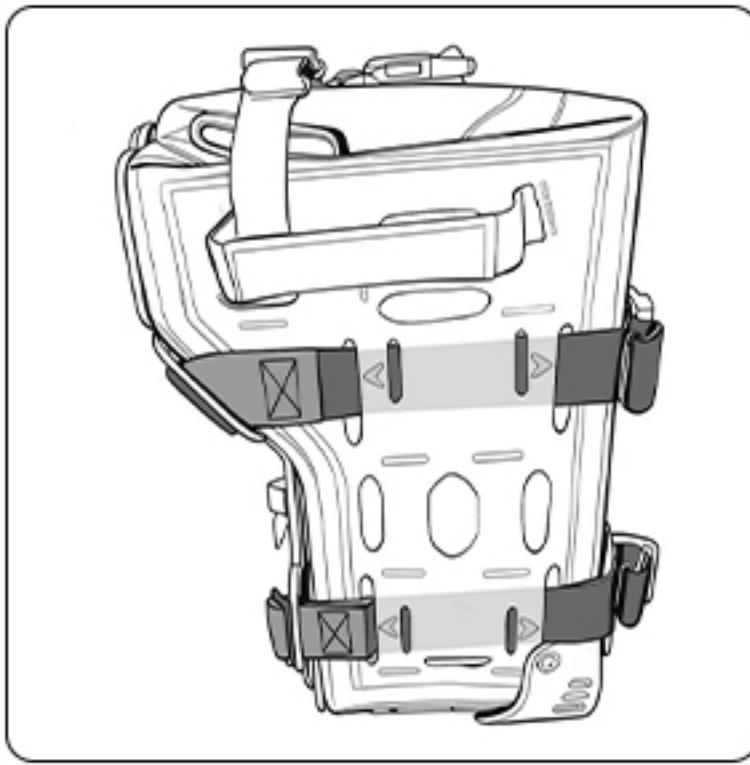

STEP10

Pass the rectangular buckle strap on the side of the mounting harness through the MOLLE structure on the bag body, then thread it through the back plate.

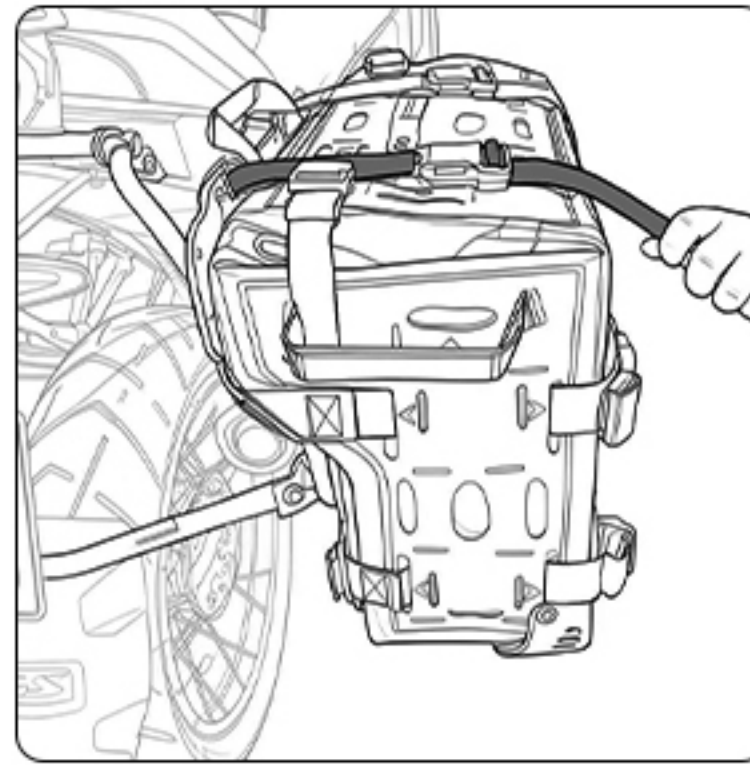

STEP11

After mounting the bag onto the motorcycle, tighten the straps securely.

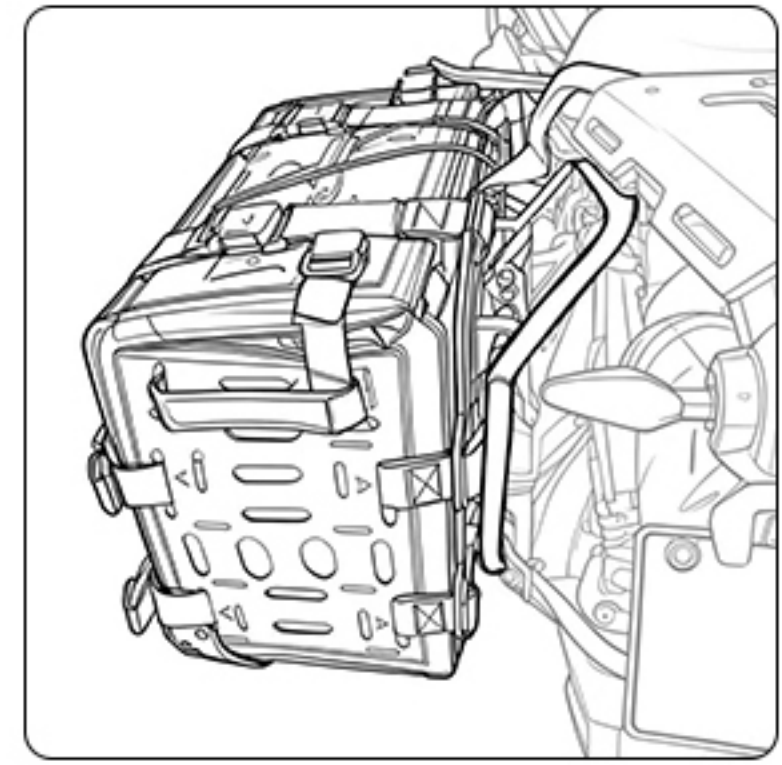

STEP12

Standard side (non-offset exhaust) installation.



Exploded View

Parts List

Serial Number	Part Name	Quantity
1	Heavy Cavalry mounting harness	1
2	Back plate	1
3	Round head hex socket screw M6 x 16	4
4	Hex lock nut	4
5	M6 washer	4

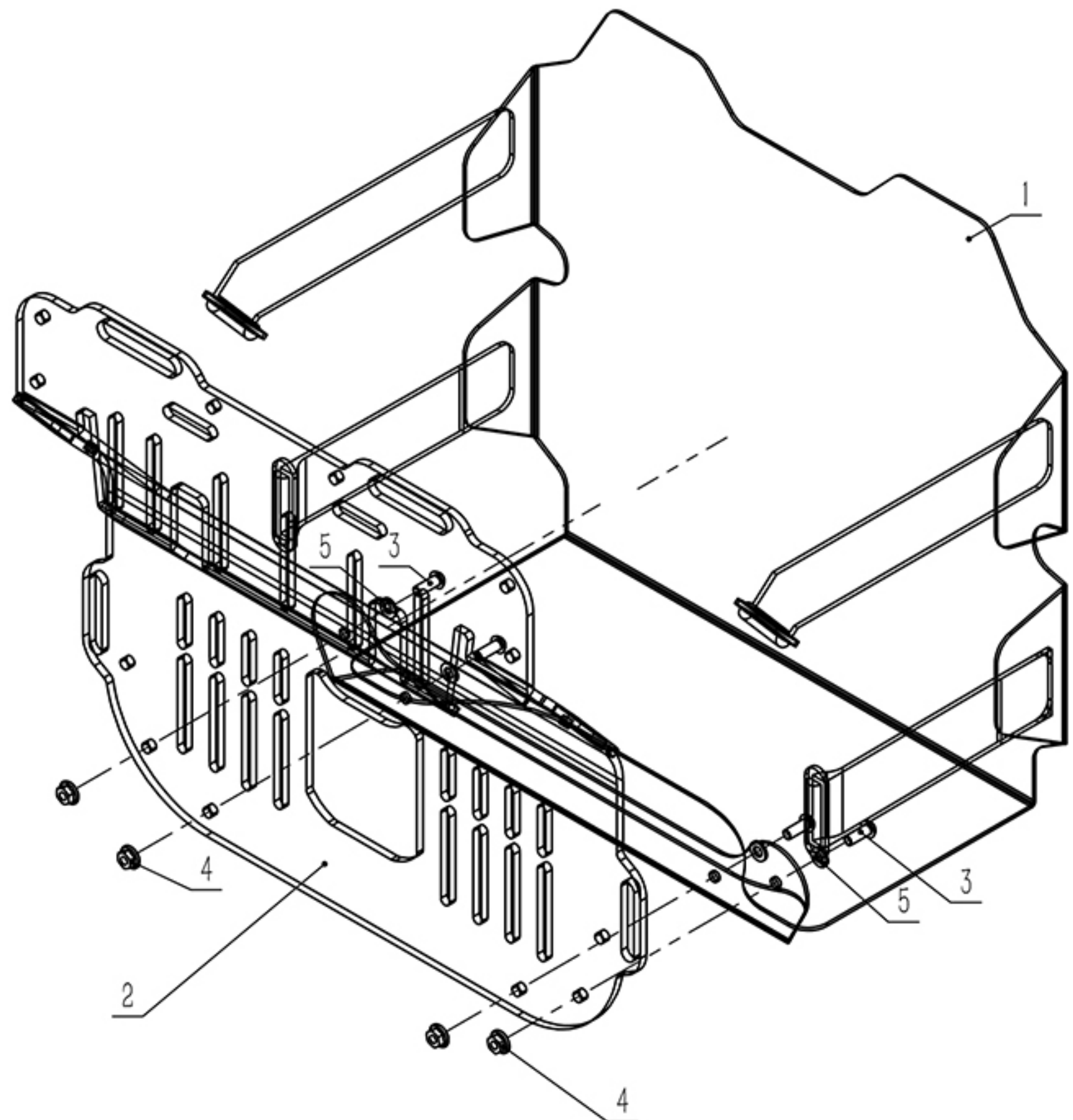

Mounting harness installation exploded view

Parts List (Non-Exhaust Side)

Serial Number	Part Name	Quantity
1	Quick release lock	1
2	Positioning crossbar	2
3	Locking tab	4
4	Key	1
5	Round head hex socket screw M6 x 18	7
6	Round head hex socket screw M6 x 16	7
7	Standard back plate	1

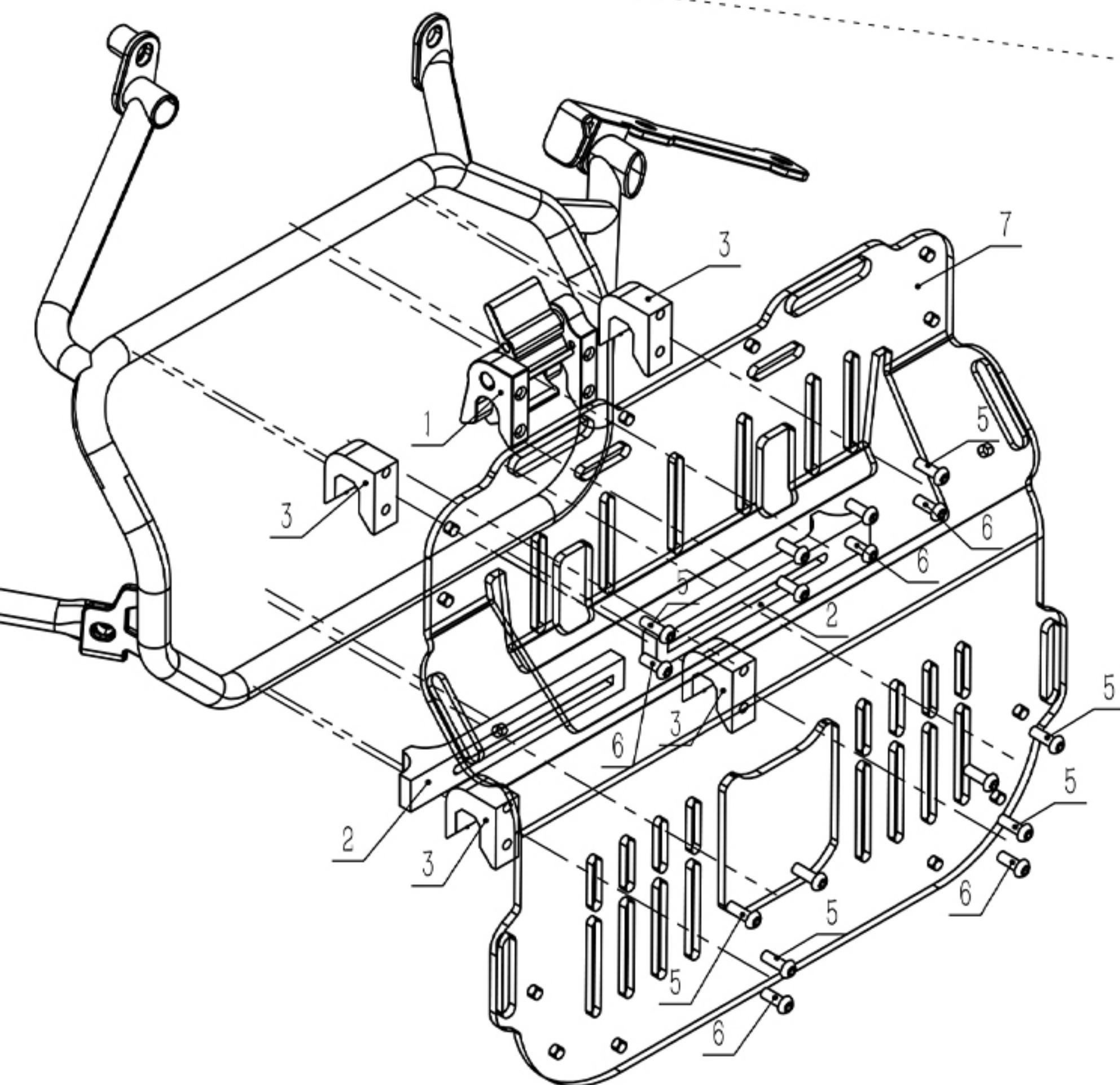
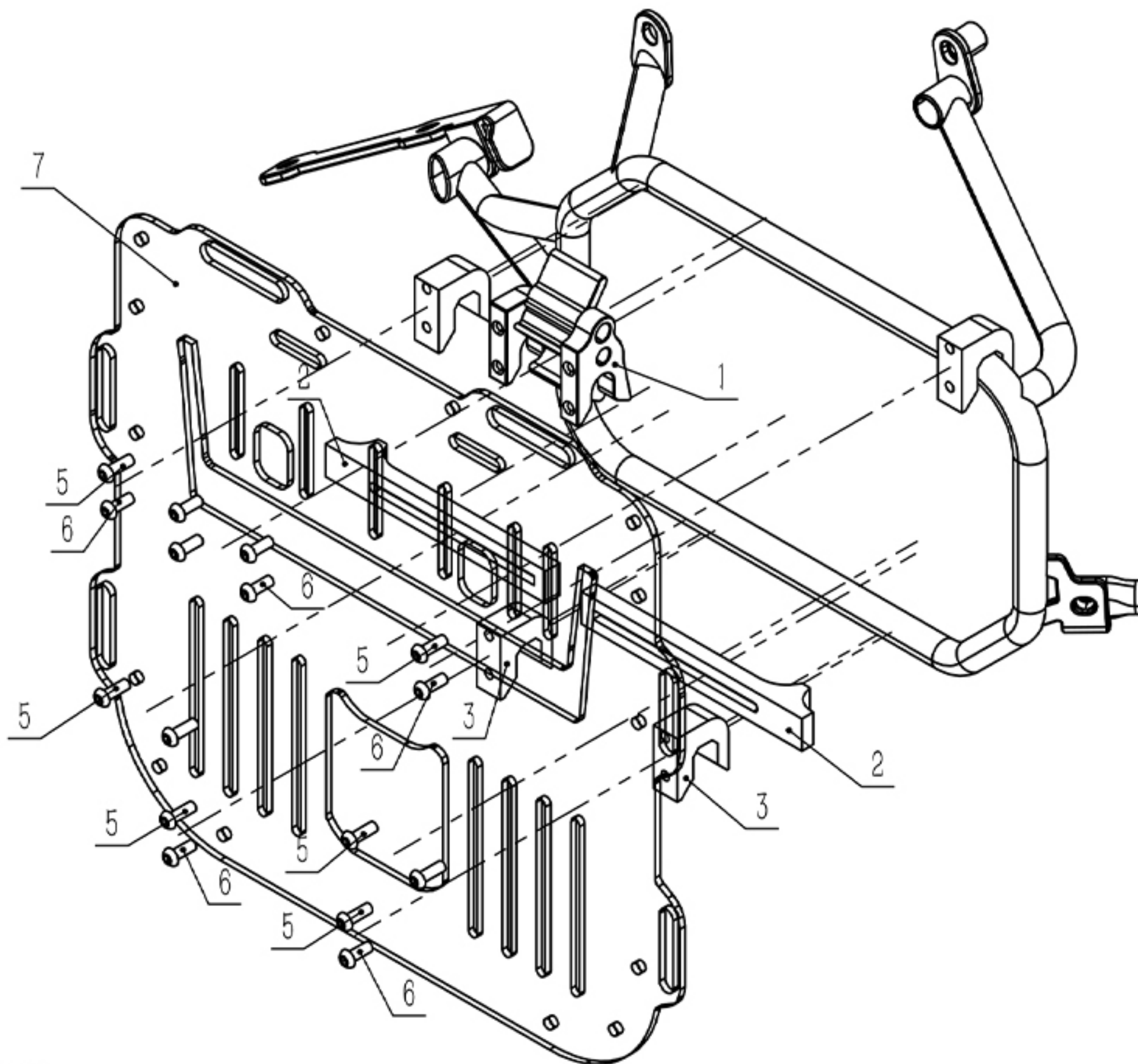

Parts List (Exhaust Side)

Serial Number	Part Name	Quantity
1	Quick release lock	1
2	Positioning crossbar	2
3	Locking tab	4
4	Key	1
5	Round head hex socket screw M6 x 18	7
6	Round head hex socket screw M6 x 16	7
7	Offset exhaust back plate	1

Back plate installation exploded view



Maintenance and Care

- **Cleaning :** Wipe the surface with a damp cloth and mild soap, then let it air dry naturally. Do not machine wash.
- **Storage :** Store in a cool, dry place and avoid long-term exposure to direct sunlight.
- **Inspection :** Regularly check the stitching, straps, buckles, and hooks for signs of wear or corrosion.



After-Sales Service

Westwind Moto: Your Ride, Our Commitment

Built for the Long Haul & Backed for Life

At Westwind Moto, we pour relentless dedication into every stitch and seam. Our gear is crafted to endure the harshest adventures, and we stand firmly behind it with two core commitments designed for riders:

- **1. Our Lifetime Craftsmanship Promise:**

The Guarantee: Every Westwind Moto product carries our Lifetime Warranty against defects.
Covered: Failures directly caused by flaws in materials or factory workmanship.
Our Action: We will repair or resolve the issue at no cost to you.

- **2. Our Lifelong Ride Protection:**

- **The Situation:** Accidents happen, even to the toughest gear. If your Westwind Moto luggage or apparel is functionally damaged in a crash – anytime, anywhere in its life.

- **Our Support:**

First Option: One free repair to restore full functionality.
Second Option: If the damage is beyond repair, receive a 50% discount on a current replacement.

- **Focus:** This pledge covers crash-induced functional impairment only.

- **Understanding Coverage:**

Lifetime Craftsmanship Promise: Addresses inherent manufacturing flaws.
Lifelong Ride Protection: Addresses functional failure from riding accidents.
Not Covered by Either: Routine wear and tear, surface scuffs/scratches (cosmetic damage), or natural breakdown over time.

- **How We Stand By You:**

Encounter an issue? Reach out to our Rider Support team (ridersupport@WestwindMoto.com) . We'll guide you through the simple steps to evaluate your gear under the relevant commitment and get you back on the trail.



website



 www.westwindmoto.com