



## CG2 用户手册 User manuals

### 欢迎使用CHIGEE CG 机车手机支架 这是一款机车领域极具创新的产品

安装、使用本产品前请先阅读本使用指南，并保留备用  
Before installing and using this product, please read this guide and keep it for future use

#### 1 产品特性

- 一秒单手拆装手机
- 不同尺寸手机无线充电位居中，无线充电效率更高
- 手机支持臂自锁防脱
- 悬浮减震设计，大幅减少手机震动损坏几率
- 15W Qi标准 大功率无线快速充电
- 25W PD协议 Type-C 大功率有线快速充电接口
- IP67级别防尘防水、无惧风雨沙尘
- 支架可自由旋转摆动
- 待机零电流极低功耗设计
- 电池低压保护功能
- 适用各种车型安装



CHIGEE官方网站  
www.chigee.com

注：CG2手机支架拆装、手机时中、夹持自锁结构受国家专利保护  
待机零电流即可忽略不计的最低电流(12V/10AH电瓶理论待机时间50年)  
手机减震设计为过滤高频高强度震动，主要功能为保护手机，并不能完全隔离震动

#### 2 适用机型尺寸



注：以上尺寸为极限尺寸范围，建议使用手机保护套以增加锁定摩擦力，请以带保护套后的尺寸为准

#### 3 包装清单



CG支架x1



电源连接线x1



工具x4



说明书x1



管夹固定座x1

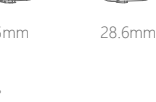

管夹变径套x3

#### 4 产品结构及说明

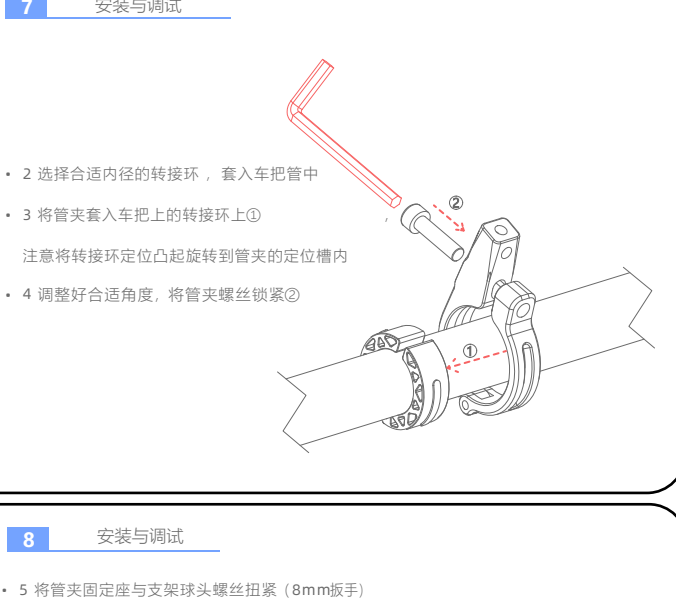

#### 5 产品结构及说明

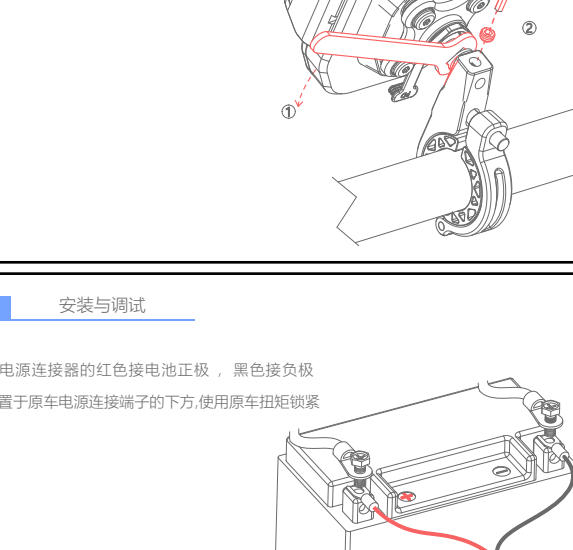

#### 6 安装与调试

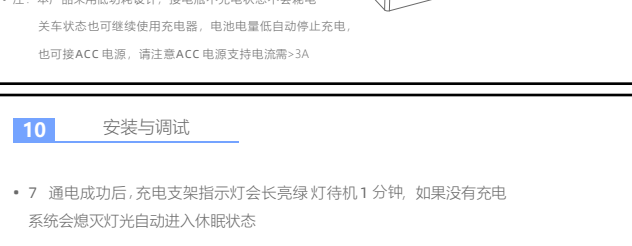

- 1 管夹固定座有2种安装方式，选择一种适合您车辆的安装方式。

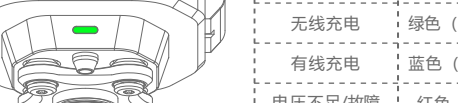

注：更多安装固定配件请关注CHIGEE官网或网络直营店

#### 7 安装与调试

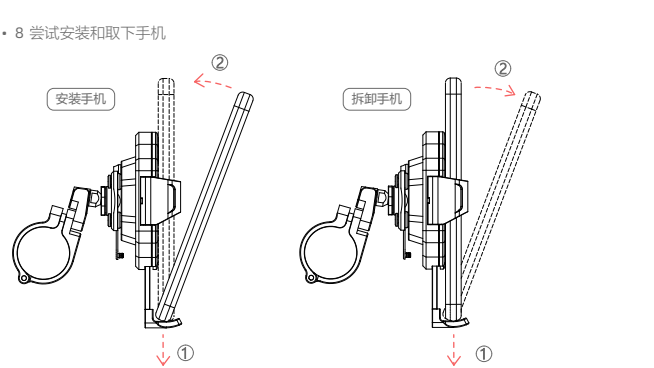

#### 8 安装与调试

- 5 将管夹固定座与支架球头螺丝扭紧（8mm扳手）  
并将机米螺丝锁入侧孔中防止松动



#### 9 安装与调试

- 6 电源连接器的红色接电池正极，黑色接负极  
放置于原车电源连接端子的下方,使用原车扭矩锁紧



注：本产品采用低功耗设计，接电瓶不充电状态不会耗电  
关车状态也可继续使用充电器，电池电量低自动停止充电。  
也可接ACC电源，请注意ACC电源支持电流需>3A

#### 10 安装与调试

- 7 通电成功后，充电支架指示灯会亮绿灯待机1分钟，如果没有充电  
系统会熄灭灯光自动进入休眠状态

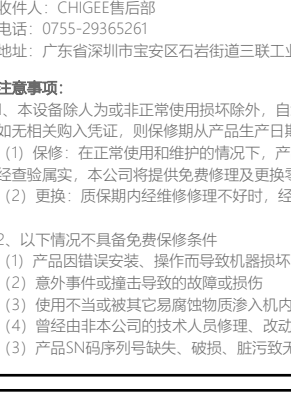

工作指示灯说明		
工作状态	灯光状态	
待机	绿色	●
无线充电	绿色（呼吸灯）	●
有线充电	蓝色（呼吸灯）	●
电压不足/故障	红色（闪烁）	●
休眠	熄灭	●

#### 11 安装与调试

- 8 尝试安装和取下手机

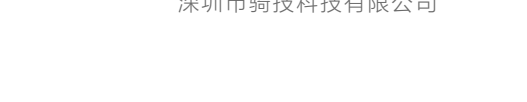

- 9 使用带无线充电功能的手机测试支架无线充电功能，使用数据线测试有线充电功能
- 10 完成

#### 12 日常使用须知

1 CG手机支架防水级别为IP67，包含Type-C接口，即使Type-C接口不套入防尘套也为防水状态，套入防尘套能避免Type-C接口堆积灰尘，延长使用寿命

2 日常洗车操作，不要使用腐蚀性清洗剂擦洗产品（可能导致防水结构损坏），  
尽量避免高压水枪直接冲洗，如有必要，请保持1米以上冲洗距离

3 在下雨时应尽量避免使用有线充电，避免因电流腐蚀充电接口

4 请配合使用塑胶手机保护套以增加锁定摩擦力

#### 13 技术参数

产品名称	CHIGEE 机车无线充电手机支架
产品型号	CG2（无线充电和有线充电）
外形尺寸	86*76*43mm
重量	165g
工作电压	11.5 - 18V
工作电流	2.5A Max (12V)
待机电流	<20uA
无线充电功率	15W Max
无线充电支持协议	Qi 15W/ 苹果 7.5W
有线充电功率	25W Max
有线充电接口	TYPE-C
有线充电支持协议	PD3.0/QC3.0/SCP/FCP/VOOC/Apple
保险丝规格	3A 迷你保险丝
防护等级	IP67

#### 14 故障分析与排除

故障现象	原因分析	解决方法
支架球头松动	球头螺母压紧力度不足	使用16MM扳手扭紧螺母至合适紧动力度
通电不工作或红灯闪烁	电源正负极接反、电池电压不足	检查电源连接、电池电压需大于11.5V
无线充电不能工作	有线充电优先	拔除有线充电数据线，恢复无线充电功能
无法进入待机状态		支架活动机构归位和拔出数据线再尝试
排除上述问题仍不能正常工作	电路损坏	联系我们返厂维修

#### 15 售后服务

产品需维修时，请与我司售后服务部联系，经确认后，请填写好问题说明、回寄地址、和产品一起妥善寄回我司售后服务部进行维修

##### 售后地址

收件人：CHIGEE售后部  
电话：0755-29365261  
地址：广东省深圳市宝安区石岩街道三联工业区二栋二层

##### 注意事项：

1、本设备除人为或非正常使用损坏外，自您购买产品之日起算，设备保修一年  
如无相关购入凭证，则保修期从产品生产日期开始实施。

（1）保修：在正常使用和维护的情况下，产品本身机件材料，工艺及电路出现问题或故障，  
经查验属实，本公司将提供免费修理及更换零件

（2）更换：质保期内经维修修理不好时，经售后维修人员确认，可以更换相同型号的设备

2、以下情况不具备免费保修条件

- （1）产品因错误安装、操作而导致机器损坏
- （2）意外事件或撞击导致的故障或损伤
- （3）使用不当或被其它腐蚀性物质渗入机内造成损伤
- （4）曾经由非本公司的技术人员修理、改动、改装、用户自行更换机内任何部件
- （3）产品SN码序列号缺失、破损、脏污致无法识别

感谢您对CHIGEE骑技科技的支持！

深圳市骑技科技有限公司

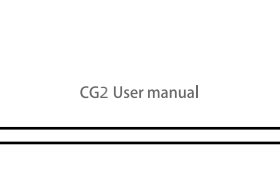

## CG2 User manual

Welcome to use CHIGEE motorcycal cell phone mount  
**This is a very innovative product in motorcycal area**

Please read the user manual before install and use the product,  
keep the manual for future use

### 1 Product features

- Easy to use (within 1 second to Install and detach )
- Higher charging efficiency among a host of other cell phone wireless charger mount
- cell phone clamping arm auto-locking and anti-detaching (over 200KM/H speed test)
- Suspension shock absorbing design reduces the probability of vibration damage of cell phone
- 15W high-power wireless fast charging
- 25W PD protocol Type-C wired fast charging
- IP67 dustproof and waterproof function
- 360 degree rotate and swing
- "0" power consumption design on standby mode
- Low-voltage battery protection function
- Suitable to all kinds of motorcycal



www.chigeetech.com

Note : The designing of CHIGEE mobilephone stand install-detach, charging coil automatic alignment functions are protected by the patent law  
"0" power consumption refers to negligible and extremely low current (in theory the 12V /10AH battery could standby 50 years.)  
cell phone Mount Suspension shock absorbing design is to reduce the probability of vibration damage of cell phone on maximum extent which do not means completely reduce the vibration.

### 2 Applicable cell phone model size

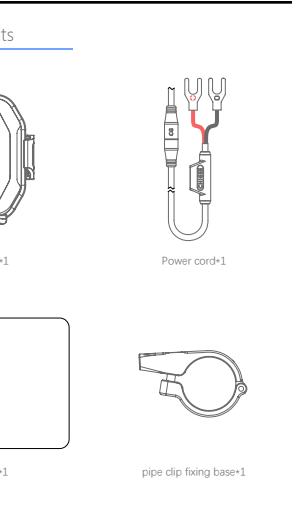

Note: The above size is the limit size. It is recommended to use the cell phone protective case to increase the locking friction. Please refer to the size with the protective case

### 3 package parts

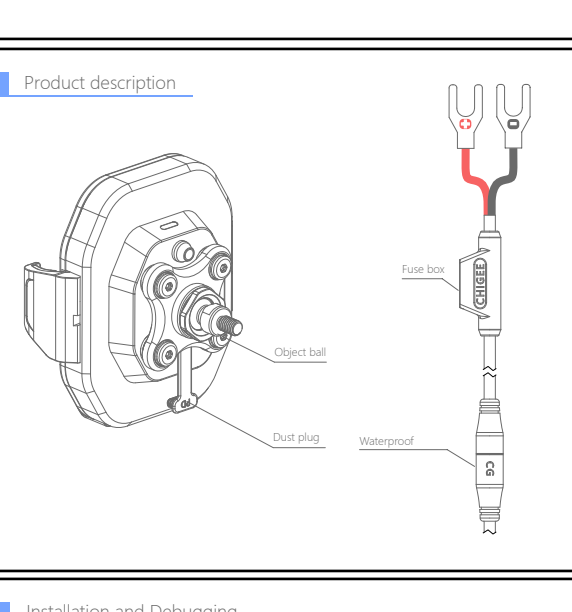

### 4 Product description

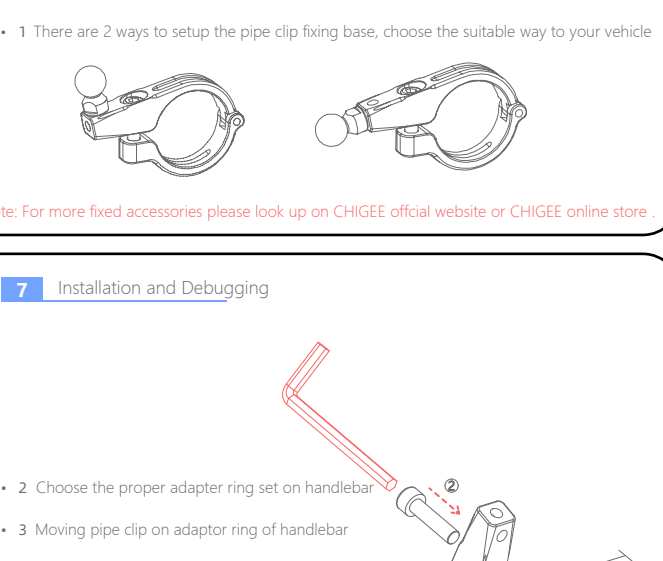

### 5 Product description

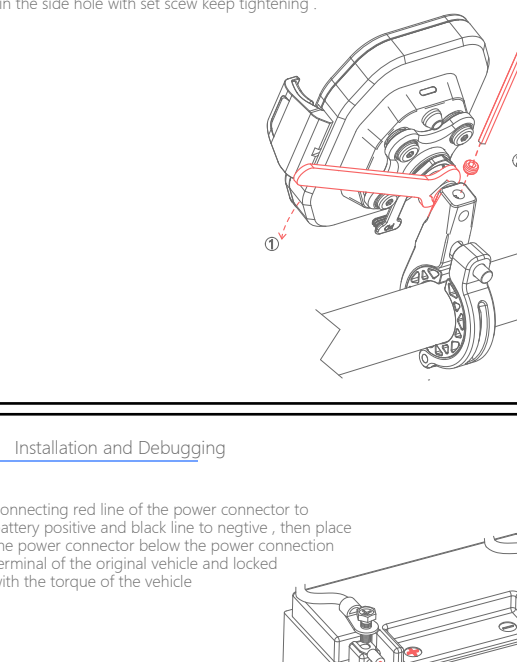

### 6 Installation and Debugging

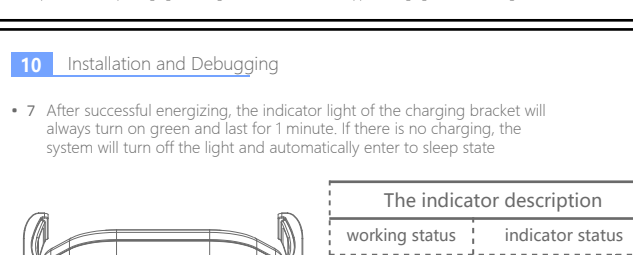

- 1 There are 2 ways to setup the pipe clip fixing base, choose the suitable way to your vehicle

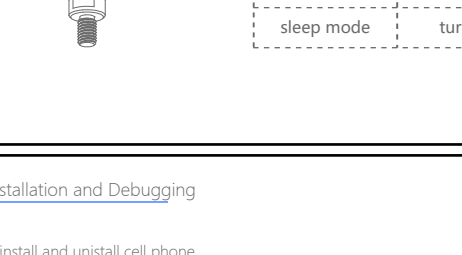

Note: For more fixed accessories please look up on CHIGEE official website or CHIGEE online store .

### 7 Installation and Debugging

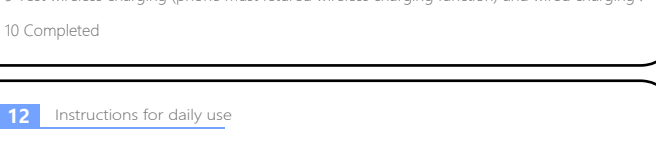

### 8 Installation and Debugging

- 5. Connecting the pipe clip base with cellphone mount and tightening the screw. Fill in the side hole with set scw keep tightening .

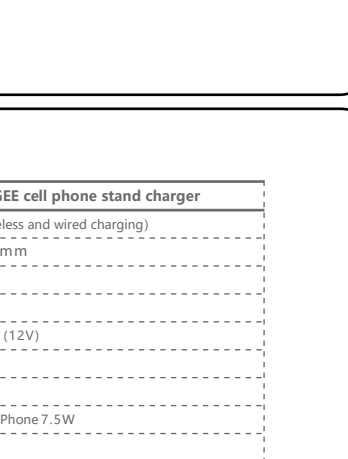

### 9 Installation and Debugging

- 6. Connecting red line of the power connector to battery positive and black line to negtive , then place the power connector below the power connection terminal of the original vehicle and locked with the torque of the vehicle

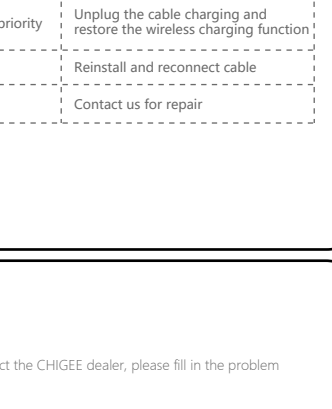

Note 1.the product designed with low power consumption , it wouldn't consuming any power when not charging  
2.cell phone can keep charging even engine off and automatic stopped charging when low voltage is checked.,

### 10 Installation and Debugging

- 7 After successful energizing, the indicator light of the charging bracket will always turn on green and last for 1 minute. If there is no charging, the system will turn off the light and automatically enter to sleep state



The indicator description		
working status	indicator status	
standby	green	●
wireless charging	green (breathe)	●
wired charging	blue (breathe)	●
low voltage/ fault	red(twinkle)	●
sleep mode	turn off	●

### 11 Installation and Debugging

- 8 Try to install and unistall cell phone



- 9 Test wireless charging (phone must fetured wireless charging function) and wired charging .
- 10 Completed

### 12 Instructions for daily use

- 1 CG cell phone Mount is ip67 in waterproof level, including Type-C interface, which is waterproof even if type-C interface is not fitted with dust coat. Fitting into the dust coat can avoid dust accumulation on Type-C interface and prolong its service life
- 2 During daily vehicle washing, do not use corrosive detergent to scrub products (which may cause damage to the waterproof structure). Try to avoid direct washing by high-pressure water gun. If necessary, please keep a washing distance of more than 1 meter.
- 3 Avoid wired charging when it rains, and avoid corrosion of charging interface due to current
- 4 Please cooperate with the use of plastic cell phone covers to increase the locking friction

### 13 technical parameters

Product name	CHIGEE cell phone stand charger
Product model	CG2 ( Wireless and wired charging)
Outlet dimension	86*76*43mm
Weight	165g
Working voltage	11.5 -18V
Working current	2.5A Max (12V)
standby current	<20uA
wireless charging power	15W Max
wireless charging support protocol	Qi 15W/ iPhone 7.5W
Wired charging power	25W Max
Wired charging interface	TYPE-C
wired charging support protocol	PD3.0/QC3.0/SCP/FCP/VOOC/Apple
Fuse model	3Amini fuse
protection level	IP67

### 14 Fault analysis and troubleshooting

Fault symptom	analysis of causes	solution
object ball loosening	The nut of object ball not tightening	Use 16MM wrench to tighten the nut to a proper swinging force
working or the red light is flashing	Connected wrong to The positive and negative poles, Power supply voltage is insufficient	Check the power connection and battery voltage shall be higher than 11.5V
wireless charging not working	Wired charging priority	Unplug the cable charging and restore the wireless charging function
unable to enter standby mode		Reinstall and reconnect cable
The others	Circuit damage	Contact us for repair

### 15 Aftersale service

If the product needs after-sales service, please contact the CHIGEE dealer, please fill in the problem description and contact address

#### Notes:

1. The equipment is guaranteed for one year from the date of purchase, except for damage caused by artificial or abnormal use.If there is no relevant purchase certificate, the warranty period starts from the production date of the product.  
(1) Warranty: in the case of normal use and maintenance, the equipment have any problem or failure in the material, process and circuit of the machine itself, after company confirmation, we will provide free repair and replacement of parts  
(2) Replacement: If the equipment can not be repaired well within the warranty period, after the maintenance staff confirmed that the same type of equipment will be replaced.

2. The following conditions do not qualify for free warranty  
(1) The machine is damaged due to improper installation and operation of the product.  
(2) Failure or damage caused by accident or collision.  
(3) Improper use or other corrosive substances into the machine caused damage.  
(4) Has not been the company's technical personnel repair, modify, refit, the user by themselves to replace any parts in the machine.  
(5) The SN code serial number of the product cannot be recognized due to absence, damage or dirt

Thanks for supporting CHIGEE!

CHIGEE TECHNOLOGY CO.,LIMITED