



Metal back plate

26+28/30+35

## HUSSAR PANNIERS

---

USER MANUAL



## Safety Warning

- Safety first. Please read this manual carefully before installation. Incorrect installation may cause the panniers to detach while riding and lead to a serious accident.
- When installing or removing the panniers, make sure the motorcycle is stable, for example use the center stand, and turn off the engine.
- Regularly check all connection points such as hooks, straps, and buckles for wear or damage to ensure they are in good condition before long rides.
- Keep the panniers and straps away from the exhaust, wheels, chain, brake discs, and all moving or high temperature components.
- Distribute items evenly inside the bags. Avoid having the center of gravity too high or too much to one side.



## Parts Checklist

- Before starting the installation, please confirm that you have received all of the following components:

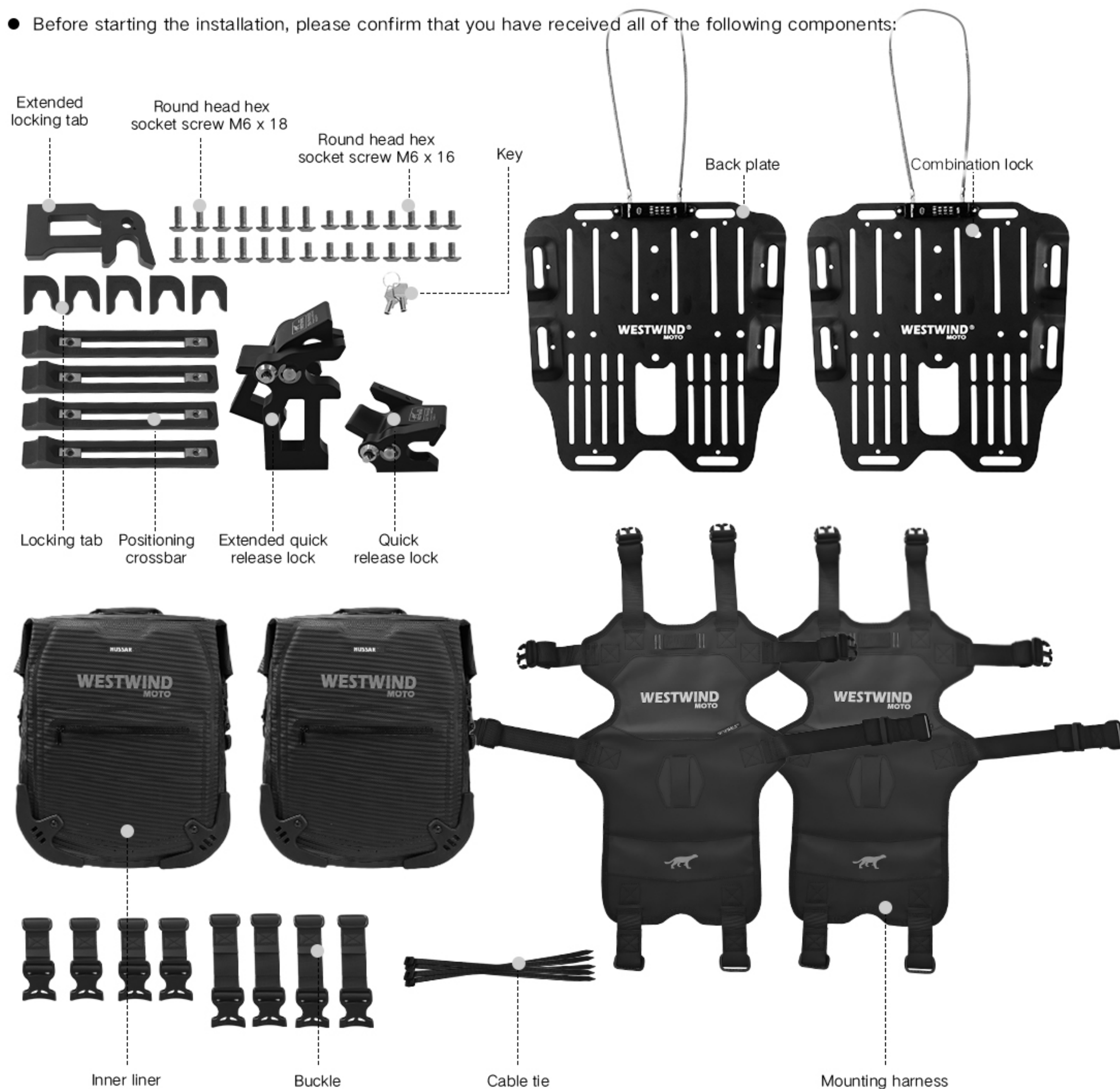





## Installation Steps

- This section is the core of the installation process. The text should match the images step by step, following the sequence "Step 1, Step 2, Step 3...".
- Before tightening the screws, apply a small amount of thread locker about the size of a grain of rice to the screws for added stability. The following steps show the installation for the offset exhaust side. The standard side follows the same process, except the quick release lock and upper extended locking tab are replaced with shorter versions.

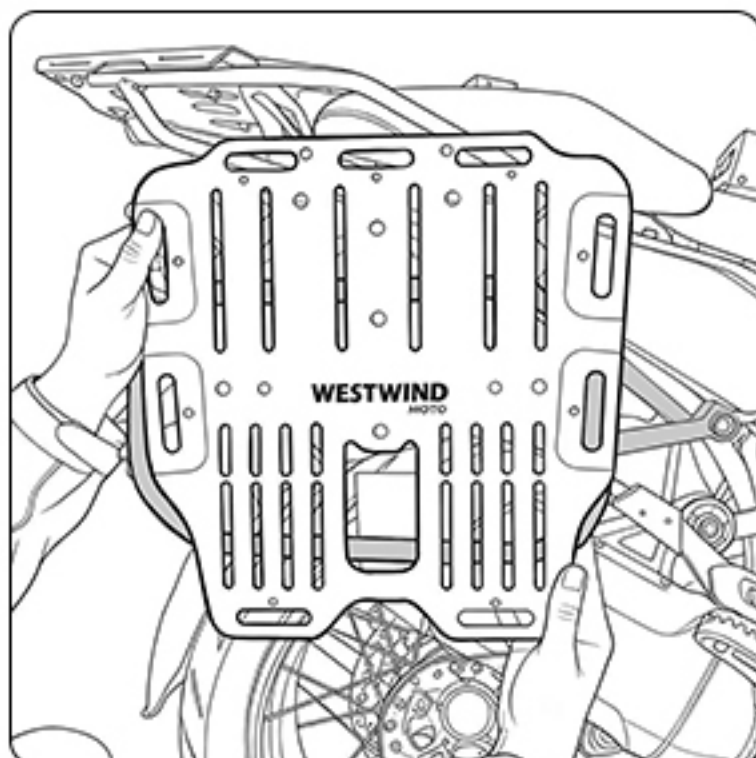

### STEP1

Position the back plate on the side rack and align it correctly.

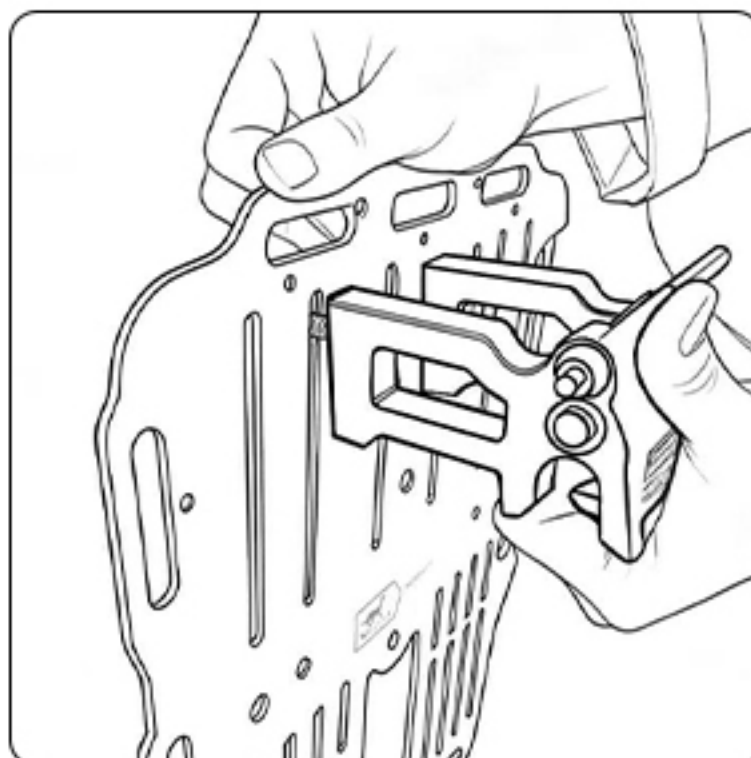

### STEP2

Install the quick release lock on the back side of the back plate (the side with the small logo). Rotate the extended quick release lock toward the marked direction until secure, then loosely fasten it in place with the short screws.

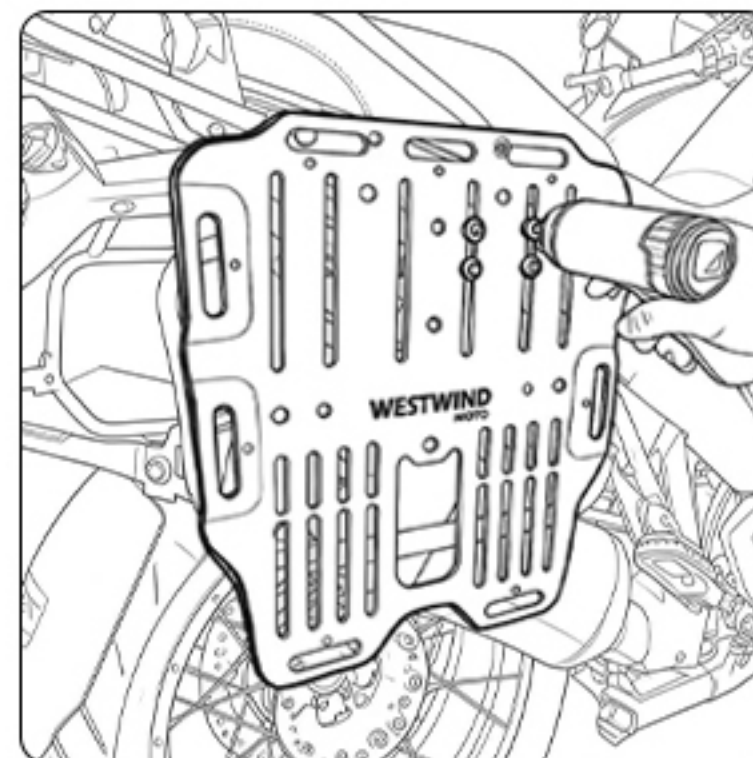

### STEP3

Clamp the back plate onto the side rack to check whether the position is correct, then tighten the screws. If the quick release lock is engaged, use the key to unlock it.

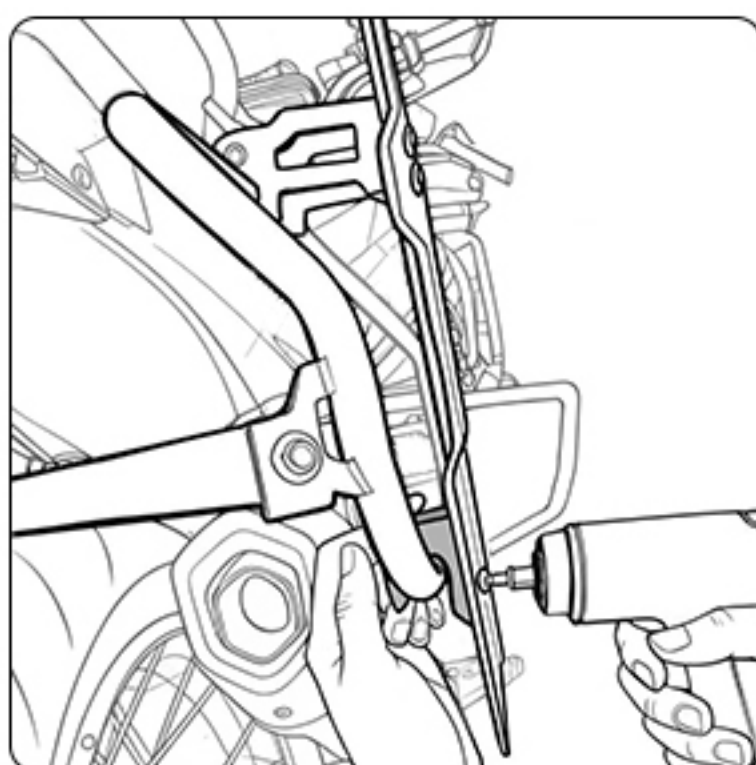

### STEP4

Install the short locking tabs on both lower sides, preferably near the outer edges. Hold each tab by hand, use long screws for the upper holes, and short screws for the lower ones.

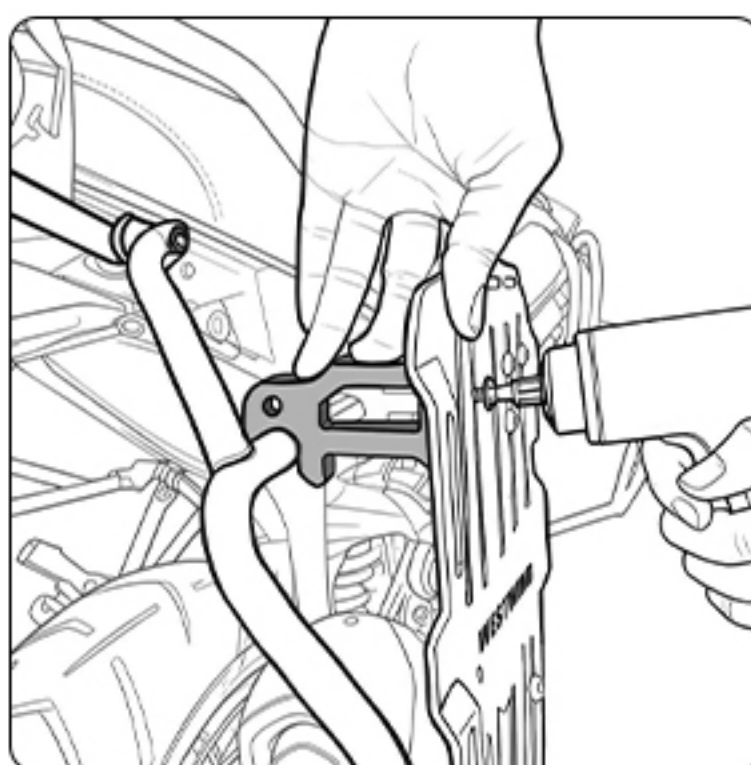

### STEP5

Position the extended locking tabs on the side rack, align the holes, and tighten them with two short screws.

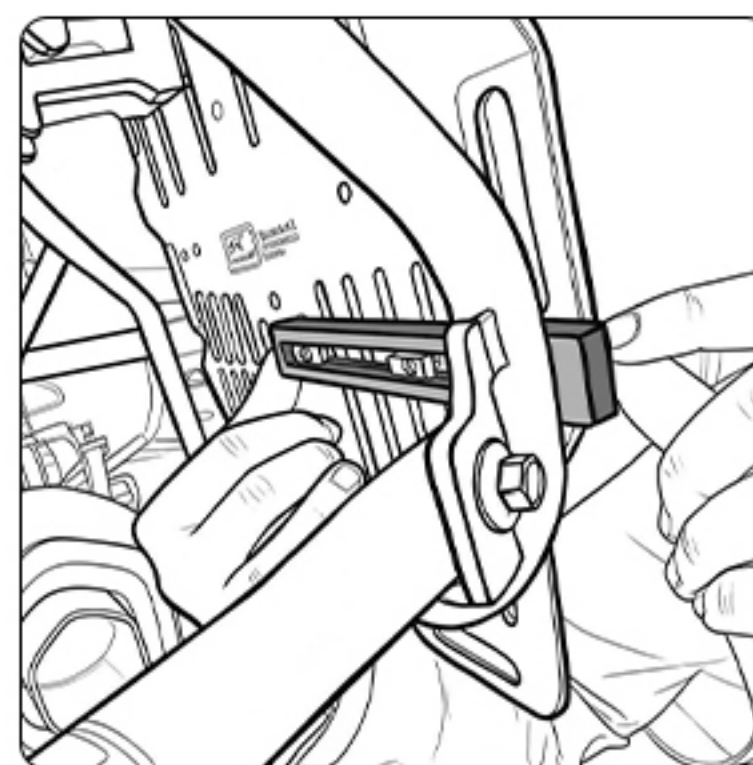

### STEP6

Place the positioning crossbar against the rack, move the sliding nuts to align with the holes, then hold the crossbar firmly against the rack and tighten with long screws. Install on both sides. Once all positions are adjusted, securely tighten all screws.

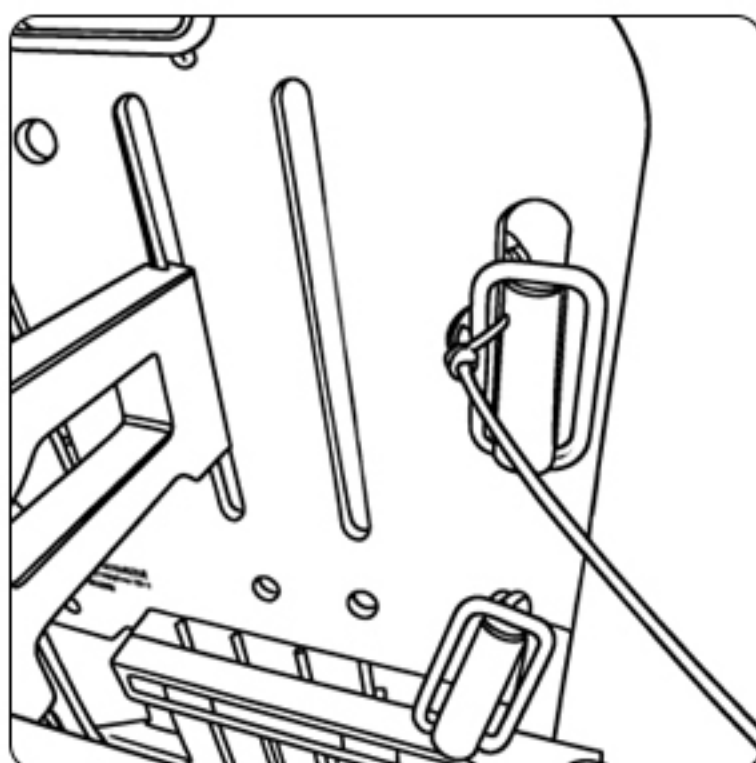

### STEP7

Insert the rectangular buckles on both sides of the mounting harness into the corresponding holes, then feed cable ties through the small holes to secure the buckles in place.



### STEP8

Insert the inner liner, feed the top rectangular buckles through the upper holes, and fasten the side buckles. Make sure that the mounting harness and the inner liner sizes match. The size marking can be found at the bottom of the harness.

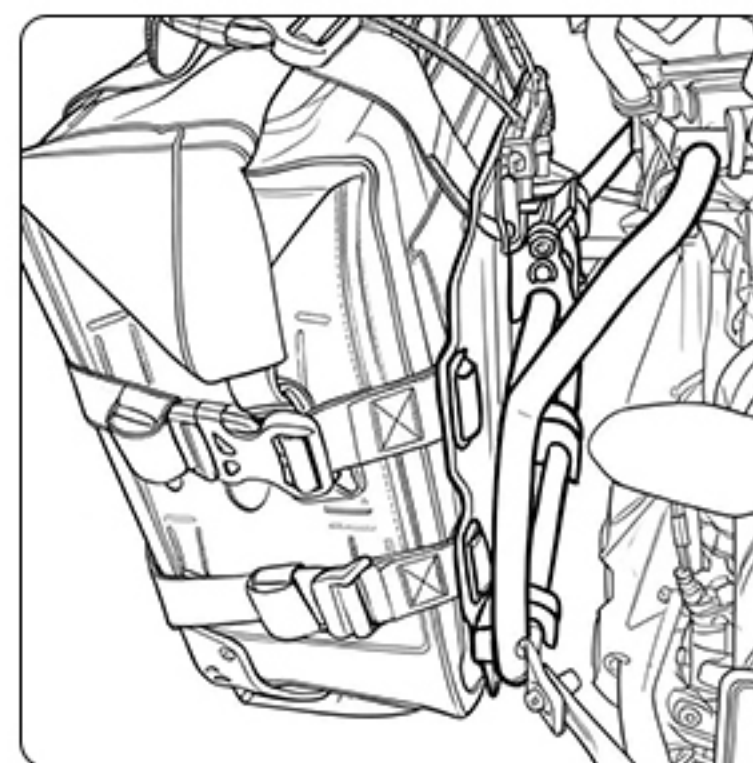

### STEP9

Standard side (non-offset exhaust) installation





## Exploded View

Use original factory screws for installation.

Parts List (Non-Exhaust Side)

| Serial Number | Part Name                           | Quantity |
|---------------|-------------------------------------|----------|
| 1             | Quick release lock                  | 1        |
| 2             | Positioning crossbar                | 2        |
| 3             | Locking tab                         | 3        |
| 4             | Key                                 | 1        |
| 5             | Round head hex socket screw M6 x 18 | 7        |
| 6             | Round head hex socket screw M6 x 16 | 7        |
| 7             | Back plate                          | 1        |

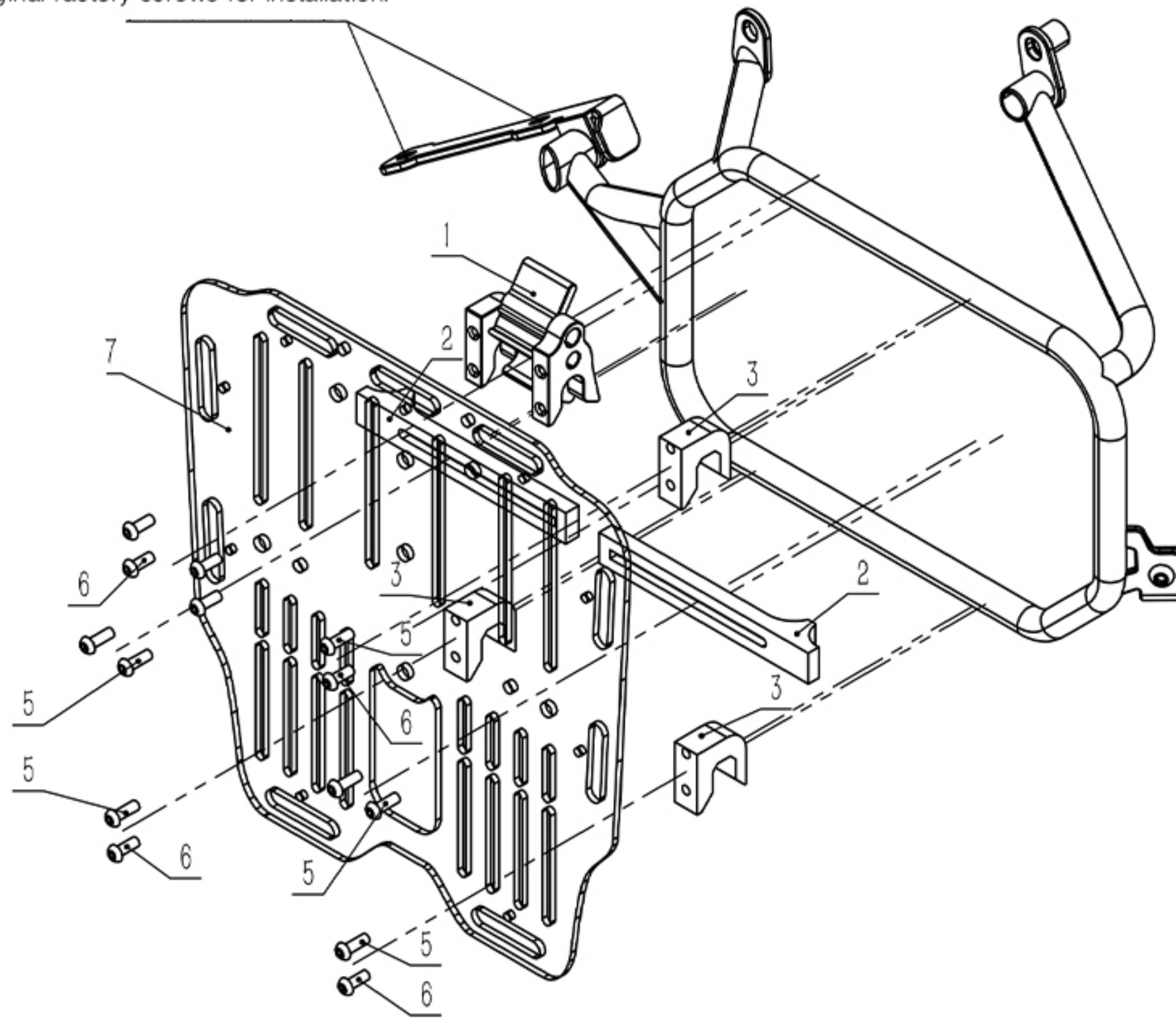

Use original factory screws for installation.

Parts List (Exhaust Side)

| Serial Number | Part Name                           | Quantity |
|---------------|-------------------------------------|----------|
| 1             | Extended quick release lock         | 1        |
| 2             | Positioning crossbar                | 2        |
| 3             | Locking tab                         | 2        |
| 4             | Key                                 | 1        |
| 5             | Round head hex socket screw M6 x 18 | 6        |
| 6             | Round head hex socket screw M6 x 16 | 8        |
| 7             | Back plate                          | 1        |
| 8             | Extended locking tab                | 1        |

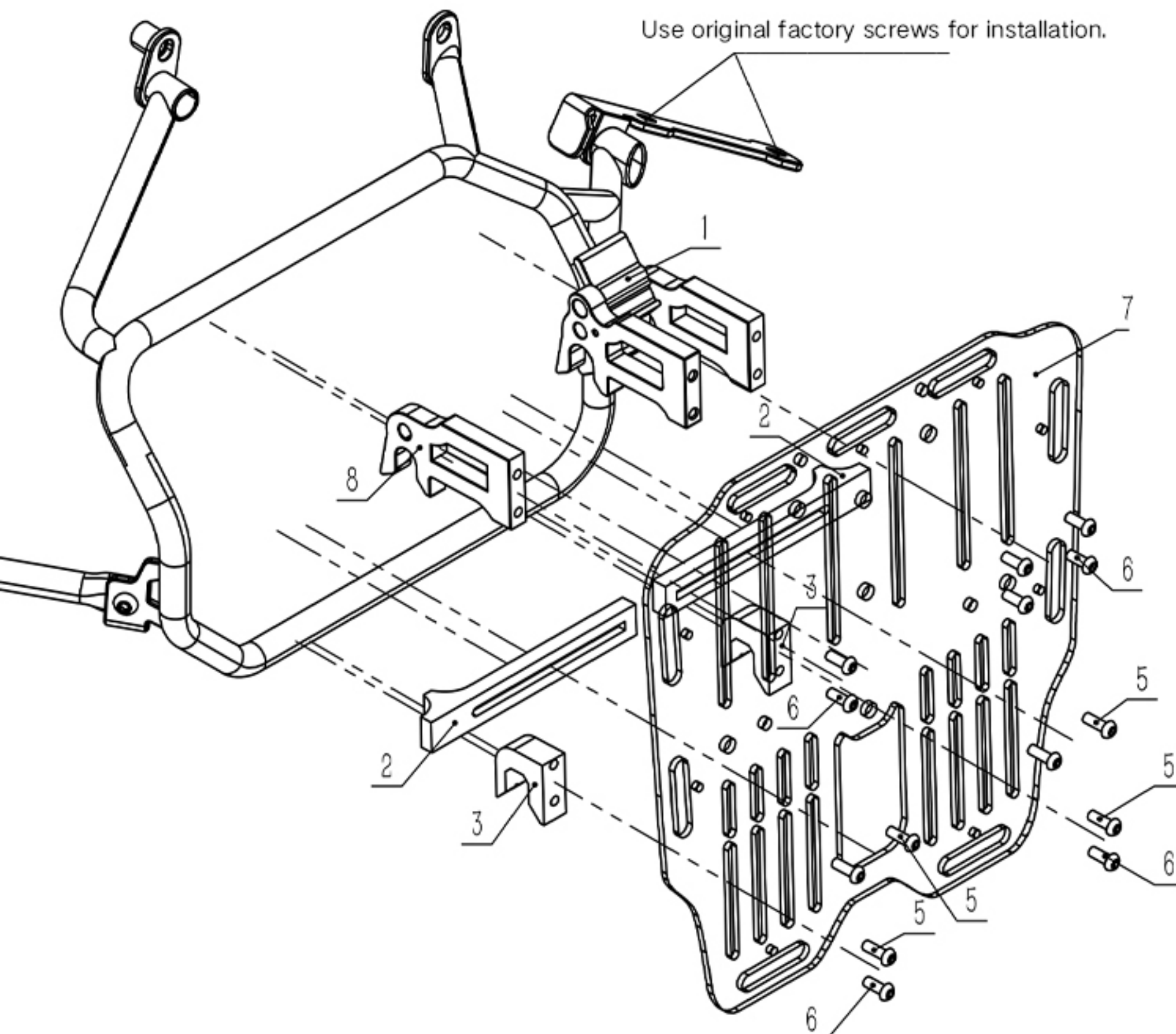





## Maintenance and Care

---

- **Cleaning :** Wipe the surface with a damp cloth and mild soap, then let it air dry naturally. Do not machine wash.
- **Storage :** Store in a cool, dry place and avoid long-term exposure to direct sunlight.
- **Inspection :** Regularly check the stitching, straps, buckles, and hooks for signs of wear or corrosion.



## After-Sales Service

---

Westwind Moto: Your Ride, Our Commitment

Built for the Long Haul & Backed for Life

At Westwind Moto, we pour relentless dedication into every stitch and seam. Our gear is crafted to endure the harshest adventures, and we stand firmly behind it with two core commitments designed for riders:

- **1. Our Lifetime Craftsmanship Promise:**

The Guarantee: Every Westwind Moto product carries our Lifetime Warranty against defects.  
Covered: Failures directly caused by flaws in materials or factory workmanship.  
Our Action: We will repair or resolve the issue at no cost to you.

- **2. Our Lifelong Ride Protection:**

- **The Situation:** Accidents happen, even to the toughest gear. If your Westwind Moto luggage or apparel is functionally damaged in a crash – anytime, anywhere in its life.

- **Our Support:**

First Option: One free repair to restore full functionality.  
Second Option: If the damage is beyond repair, receive a 50% discount on a current replacement.

- **Focus:** This pledge covers crash-induced functional impairment only.

- **Understanding Coverage:**

Lifetime Craftsmanship Promise: Addresses inherent manufacturing flaws.  
Lifelong Ride Protection: Addresses functional failure from riding accidents.  
Not Covered by Either: Routine wear and tear, surface scuffs/scratches (cosmetic damage), or natural breakdown over time.

- **How We Stand By You:**

Encounter an issue? Reach out to our Rider Support team ( [ridersupport@WestwindMoto.com](mailto:ridersupport@WestwindMoto.com) ) . We'll guide you through the simple steps to evaluate your gear under the relevant commitment and get you back on the trail.



 [www.westwindmoto.com](http://www.westwindmoto.com)



website